

CATALOGUE

SPINDLE EXTENSIONS

Operating Elements for Pipeline
Construction



DALMINEX





Foreword

Dear customer and potential customer,

We proudly present to you our new updated price list with a vast array of technical information. In the last few years it has become increasingly important to make this information available in a digital format. To access this information online go to www.dalminex.de. Here you will find a product catalogue as well as more technical information about the products such as:

- ◆ Video installation instructions as well as printable instructions
- ◆ Product catalogue in print format (without prices)
- ◆ Tender documents: technical information
- ◆ Certificates

Our marketing team works continually to maintain our product catalogue and technical information on our website to ensure that we are keeping up to date with new innovations to keep our customers happy. We also have a newsletter you can subscribe to keep you notified about any new products and updates to our service we provide.

We at DALMINEX value each and every one of our staff and customers. We look forward to working with you in the future.

With kind regards,

Markus Kerstingjöhanner
Management

Practical example



TABLE OF CONTENTS



General information

Contact	4 - 5
Quality certificate spindle extensions	6
DALMINEX - Our Company	7
Certificates	8 - 9
Technical details	10
Definition Cover depth (CD)	11

Spindle Extensions for Service valves

Telescopic spindle extension T4	14
Telescopic spindle extension T3	15
Telescopic spindle extension T3 DVGW GW336	16
Telescopic spindle extension T3 - stainless steel	17
Telescopic spindle extension T2	18
Adjustable spindle extension	19
Telescopic spindle extension T2-GREEN	20 - 21
Rigid spindle extension - Square Bar -	22
Rigid spindle extension - Round Bar -	23

Spindle Extensions for Gate valves

Telescopic spindle extension T4X	24 - 25
Telescopic spindle extension T4	26 - 27
Telescopic spindle extension T4 DVGW GW336	28 - 29
Telescopic spindle extension T3	30 - 31
Telescopic spindle extension T3 DVGW GW336	32 - 33
Telescopic spindle extension T3 - stainless steel	34 - 35
Telescopic spindle extension T3 with position indicator	36 - 37
Telescopic spindle extension T2	38 - 39
Telescopic spindle extension T2-GREEN	42 - 43
Adjustable spindle extension	44 - 45
Rigid spindle extension - Square Bar -	46 - 47
Rigid spindle extension - Round Bar -	48 - 49

Spindle Extensions for Butterfly valves

Telescopic spindle extension T3 with flange bell	52 - 53
Telescopic spindle extension T3 with round bell	54 - 55

Spindle Extensions for Ball valves

Telescopic spindle extension T3 with square connection	58 - 59
Telescopic spindle extension T3 with Polygon	60 - 61

Spindle Extension for special applications

Telescopic spindle extension T3 for Service valves with screw bell	64 - 65
Telescopic spindle extension T3 for Gate valves with screw bell	66 - 67

Position indicators & marking systems

Mechanical position indicator, plastic	70 - 71
Mechanical position indicator, stainless steel	72 - 73
Electrical position indicator, stainless steel	74 - 77
Position indicator, plastic	78
Marking discs & Cover caps	79

Operating keys

DIN 3223: Operating key A	82
DIN 3223: Operating key B	82
DIN 3223: Operating keys C, D, E	82
Operating keys C/E similar to DIN 3223	82
Safety handwheel wrench	82
Surface box hooks	83
Handwheels	83
Screw and washer sets	83

Accessories

Extension for service valves	86
Extension for gate valves	86
Locking device for service valves	86
Locking device for gate valves	86
Surface boxes	87
Support plates	87
Fixing disc	87
Covering caps	88
Centring caps	88
Bell adapters	88
Spindle extension components: Clip-pins, Grooved pins, Slotted spring pins, Split pins, Adjusting-rings	89
Square caps / Triangular caps	90 - 91
Couplings	91

Pipework systems

Stainless steel flange connections	94 - 95
------------------------------------	---------

General Terms & Conditions

General Terms & Conditions	98 - 99
----------------------------	---------

Our team

Management



Markus Kerstingjöhanner

Phone: +49 5207 9137-12
Mobile: +49 151 20031916

E-mail: kerstingjoaenner@dalminex.de

Controlling / Personnel



Dr. Helmut Kerstingjöhanner

Phone: +49 5207 9137-26

E-mail: h.kerstingjoaenner@dalminex.de

Management Assistant



Pia Kerstingjöhanner

Phone: +49 5207 9137-26

E-mail: p.kerstingjoaenner@dalminex.de

Chief Operating Officer / Quality Manager



Nils Raschka

Phone: +49 5207 9137-11
Mobile: +49 172 5764162

E-mail: raschka@dalminex.de

Technical Advisor



Norbert Englisch

Phone: +49 5207 9137-20
Mobile: +49 162 2432516

E-mail: englisch@dalminex.de

Sales Manager



Patrick Jackman

Phone: +49 5207 9137-22
Mobile: +49 172 5764163

E-mail: jackman@dalminex.de

Key Account Management - North/East



Karolina Krupicka

Phone: +49 5207 9137-0
Mobile: +49 171 7647738

E-mail: krupicka@dalminex.de

Key Account Manager - South/west



Maro R Emmert

Phone: +49 5207 9137-0
Mobile: +49 160 90151917

E-mail: remmert@dalminex.de

Internal Sales



Marco Bergmann

Phone: +49 5207 9137-23

E-mail: bergmann@dalminex.de

Internal Sales



Tony Schröder

Phone: +49 5207 9137-14

E-mail: schroeder@dalminex.de

Purchasing



Matthias Schlechter

Phone: +49 5207 9137-24

E-mail: schlechter@dalminex.de

Purchasing



Jie Long

Phone: +49 5207 9137-30

E-mail: long@dalminex.de

Our team



CAD



Ali Taberkent

Phone: +49 5207 9137-17

E-mail: taberkent@dalminex.de

Project Management / IT



Felix Lenzen

Phone: +49 5207 9137-19

Mobile: +49 151 61345935

E-mail: lenzen@dalminex.de

Our trainees

Trainee as Productdesigner



Paulina Pasciak

Phone: +49 5207 9137-

E-mail: pasciak@dalminex.de

Trainee as Industrial clerk



Madelene Janzen

Phone: +49 5207 9137-25

E-mail: janzen@dalminex.de

Opening hours

Office hours:

Mon. - Thu.: 07:00 - 12:00
12:45 - 17:00
Friday: 07:00 - 12:00
12:45 - 15:00

Warehouse hours:

Mon. - Fri.: 06:00 - 09:30
10:00 - 13:30



Warranty declaration

Our spindle extensions are manufactured according to the requirements of the DVGW worksheet GW336. Showing that the primary material is selected and checked accordingly.

Metallic material:

- ◆ Steel according to DIN EN 10025
- ◆ Stainless steel with a minimum of 13% chrome:
 - Standard: V2A: 1.4301 (X5CrNi18-10)
 - Upon request: V4A: 1.4571 (X6CrNiMoTi17-12-2)
- ◆ Square caps and coupling adapters are made of ductile cast iron according to DIN 3230-5. material class: WG 2 (GGG40/EN GJS400-15)
- ◆ Square caps and coupling adapters are made of ductile cast iron with a minimum of 13% chrome (AISI304)

Protection tubes:

- ◆ Polyethylen (PE-HD)
- ◆ Polypropylen (PP)
- ◆ Polyoxymethylen (POM)

Corrosion protection for corrosion-susceptible metallic material:

- ◆ Hot-dipped galvanisation of bars according to DIN EN 10240
- ◆ Galvanisation of cast iron parts according DIN EN 12329 und DIN 50961

The material thickness of the bars comply with the according minimum requirements of the worksheet DVGW GW336 and its normative references in force.

All spindle extensions are produced on our premises in Schloss Holte-Stukenbrock.

Upon professional installation we grant a warranty of 5 years.

A certification according to German Institute for Standardisation EN ISO 9001:2015 has been received.

Schloß Holte-Stukenbrock, January 2024

Markus Kerstingjöhanner,
General Manager

DALMINEX GmbH

Helleforthstraße 87
D-33758 Schloß Holte-Stukenbrock

Phone: +49 5207 9137-0

info@dalminex.de
www.dalminex.de

Subject to modifications

For over 20 years the Dalminex team has been...



...a big family



...with manufacturing competence



...with high quality

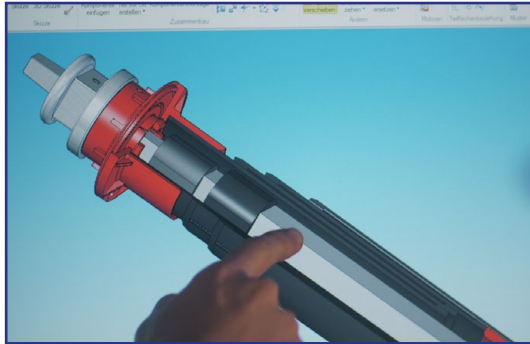

...with regular Innovations



...with efficient and quick competent customer service and support



...always with clear documentation



...and well trained, friendly staff always available to help!



CERTIFICATES

DVGW-GW336 Type examination certificate



DVGW-Baumusterprüfzertifikat
DVGW type examination certificate

DVGW CERT
DV-4595CM0081
Registrierungsnummer
registration number

Anwendungsbereich <i>field of application</i>	Produkte der Gas- und Wasserversorgung <i>products of gas and water supply</i>
Zertifikatinhaber <i>owner of certificate</i>	Dalminex GmbH Helleforthstr. 87, D-33758 Schloß Holte-Stukenbrock
Vertreiber <i>distributor</i>	Dalminex GmbH Helleforthstr. 87, D-33758 Schloß Holte-Stukenbrock
Produktart <i>product category</i>	Rohrleitungsstücke und Zubehör: Erdenbaugarnitur (4595)
Produktbezeichnung <i>product description</i>	höhenverstellbare Einbaugarnitur für erdverlegte Armaturen in der Gas- und Trinkwasserverteilung
Modell <i>model</i>	Teleskop-T3-GW336...
Prüfberichte <i>test reports</i>	Kontrollprüfung Labor: 153 939 K2019 vom 07.11.2019 (GW) Baumusterprüfung: 16624 vom 31.01.2011 (GW)
Prüfgrundlagen <i>test basis</i>	DVGW GW 336-2 (01.09.2010)

Ablaufdatum / AZ
date of expiry / file no. 31.01.2026 / 21-0341-WNV

27.04.2021 LE A-1/2
Datum, Beschriftung, Blatt, Leiter der Zertifizierungsstelle
date, issued by, sheet, head of certification body



DVGW CERT GmbH
Zertifizierungsstelle
Josef-Wilmer-Str. 1-3
53123 Bonn
Tel. +49 228 91 91 00
Fax. +49 228 91 91 01
www.dgwg-cert.de
info@dgwg-cert.de



DVGW-Baumusterprüfzertifikat
DVGW type examination certificate

DVGW CERT
DV-4595CT0447
Registrierungsnummer
registration number

Anwendungsbereich <i>field of application</i>	Produkte der Gas- und Wasserversorgung <i>products of gas and water supply</i>
Zertifikatinhaber <i>owner of certificate</i>	Dalminex GmbH Helleforthstr. 87, D-33758 Schloß Holte-Stukenbrock
Vertreiber <i>distributor</i>	Dalminex GmbH Helleforthstr. 87, D-33758 Schloß Holte-Stukenbrock
Produktart <i>product category</i>	Rohrleitungsstücke und Zubehör: Erdenbaugarnitur (4595)
Produktbezeichnung <i>product description</i>	Teleskop-Erdenbaugarnitur
Modell <i>model</i>	Teleskop-EBG T4
Prüfberichte <i>test reports</i>	Kontrollprüfung Labor: 161929 K2022 vom 16.01.2023 (GW) Ergänzungsprüfung: 161929E1/18096 vom 28.04.2021 (GW) Baumusterprüfung: 161929 T0 vom 15.05.2018 (GW)
Prüfgrundlagen <i>test basis</i>	DVGW GW 336-2 (01.09.2010)

Ablaufdatum / AZ
date of expiry / file no. 15.05.2028 / 23-0602-WNV

15.08.2023 LE A-1/2
Datum, Beschriftung, Blatt, Leiter der Zertifizierungsstelle
date, issued by, sheet, head of certification body



DVGW CERT GmbH
Zertifizierungsstelle
Josef-Wilmer-Str. 1-3
53123 Bonn
Tel. +49 228 91 91 00
Fax. +49 228 91 91 01
www.dgwg-cert.de
info@dgwg-cert.de



Quality management



CERTIFICATE

The Certification Body
of TÜV SÜD Management Service GmbH
certifies that

DALMINEX
Dalminex GmbH
Helleforthstr. 87
33758 Schloß Holte-Stukenbrock
Germany

has established and applies
a Quality Management System for

Development, Manufacturing and Distribution
of spindle extensions, operating tools for
valves and components for pipelines.

An audit was performed, Order No. 70759102.
Proof has been furnished that the requirements
according to

ISO 9001:2015
are fulfilled.

This certificate is valid from 2022-03-16 until 2025-03-15.
Certificate Registration No.: 12 100 37944 TMS.

Head of Certification Body
Munich, 2022-02-16





TÜV SÜD Management Service GmbH • Zertifizierungsstelle • Rosenstraße 67 • 80328 München • Germany
www.tuv-sud.de/certificates-validity-check



Creditreform Bielefeld
Riegel & Unger KG
awards the solvency certificate CrefoZert
to the company

**Dalminex Handelsgesellschaft mit
beschränkter Haftung -
Industriebedarf und Stahlgroßhandel**
CrefoNumber: 4010024575
Solvency Index: 178

In the course of the appraisal, the company
showed a good solvency structure and fulfilled
all certification criteria:

- Solvency Index < 250 or an external rating
better than BBB- by a recognized rating agency
- Balance sheet rating < CR8
- successful questioning of the management:
no significant credit risks noticeable

The certificate is valid for one year provided
the criteria is continuously fulfilled.

The current status can be checked here:
www.creditreform.de/crefozert

Bielefeld, 31st August 2023
Creditreform Bielefeld
Riegel & Unger KG

Chief Executive Officer





Valid until: 8/2024

Technical characteristics: Spindle extensions



Subject to technical modifications!

Definition of Cover Depth (CD)



Cover Depth (CD) is described as the length between the top of the mains pipe to the surface box lid.

The DALMINEX definition of cover depth is based on the values given in the table below. Minor deviations can occur for some valves e.g. a shorter minimum cover depth for a shorter valve and a longer maximum cover depth for a taller valve.

Valves higher or lower than the average value can possibly result in limitation of the minimum or maximum cover depth. Please indicate valve type and manufacture when ordering.

The manufacturing process may cause a tolerance of +/- 3 cm with respect to total length.

Dalminex Standard

Definition of cover depth according to DVGW GW336

Valves	H*
Service Valve	160 mm
Gate Valve DN25	160 mm
Gate Valve DN32	160 mm
Gate Valve DN40	200 mm
Gate Valve DN50	200 mm
Gate Valve DN65	240 mm
Gate Valve DN80	240 mm
Gate Valve DN100	310 mm
Gate Valve DN125	310 mm
Gate Valve DN150	310 mm
Gate Valve DN175	410 mm
Gate Valve DN200	410 mm
Gate Valve DN250	520 mm
Gate Valve DN300	520 mm
Gate Valve DN350	520 mm
Gate Valve DN400	700 mm
Gate Valve DN450	700 mm
Gate Valve DN500	800 mm
Gate Valve DN600	800 mm

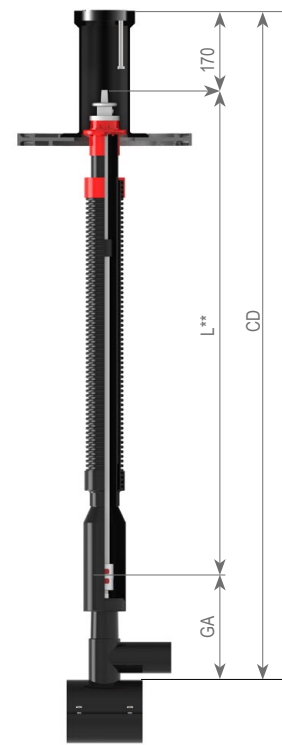

* H is the average height of most valves commercially available

** L is the length of the spindle extension

The material thickness complies with all applicable torque requirements of German Standard DVGW regulations worksheet GW336.

SPIND

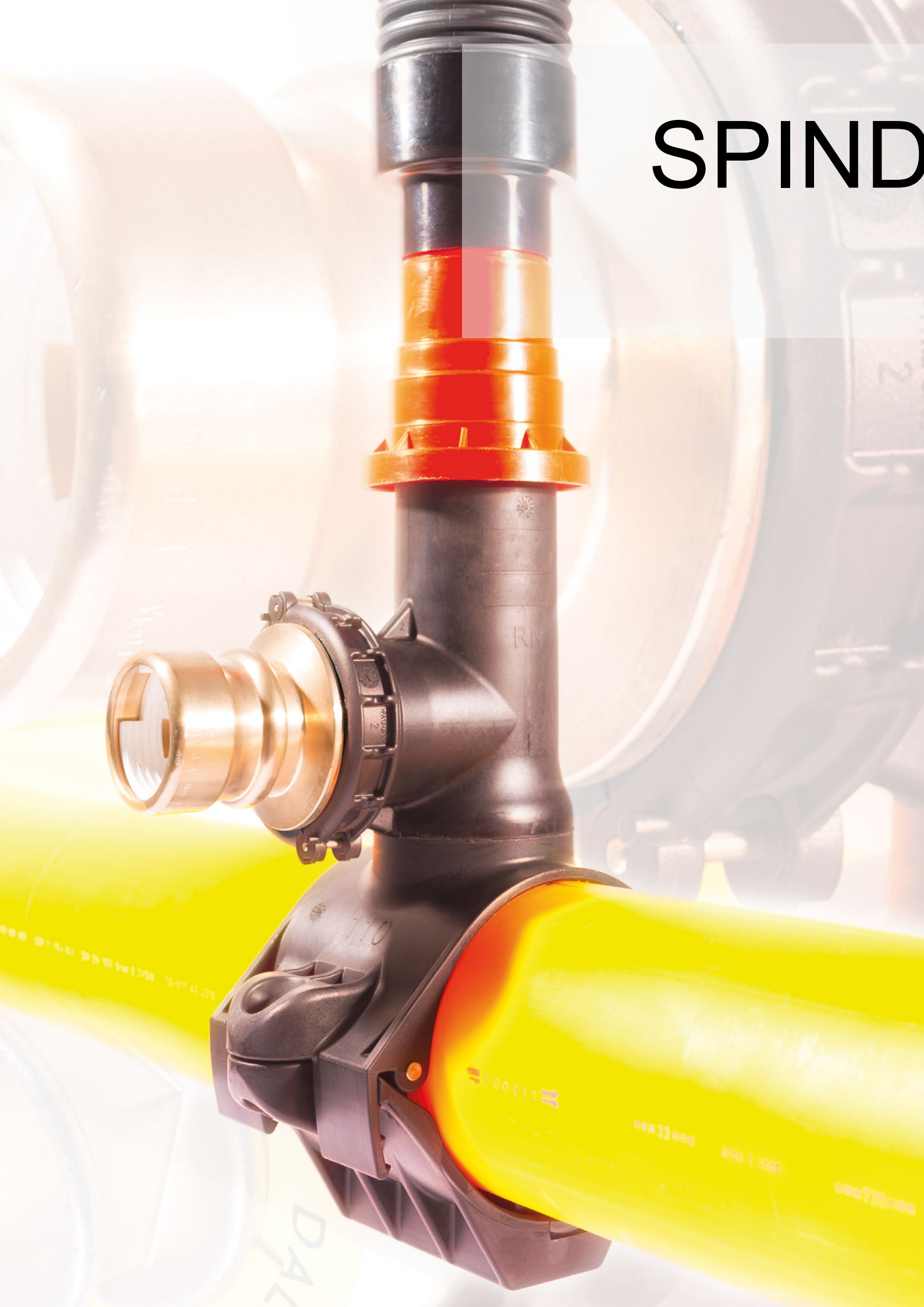

OLE EXTENSIONS

FOR SERVICE VALVES

TABLE OF CONTENTS

Telescopic spindle extension T4	14
Telescopic spindle extension T3	15
Telescopic spindle extension T3 DVGW GW336	16
Telescopic spindle extension T3 - stainless steel	17
Telescopic spindle extension T2	18
Adjustable spindle extension	19
Telescopic spindle extension T2-GREEN	20 - 21
Rigid spindle extension - Square Bar -	22
Rigid spindle extension - Round Bar -	23

SPINDLE EXTENSIONS FOR SERVICE VALVES

Telescopic spindle extension T4



①



Square cap SQ12/14

②



Centring cap

③

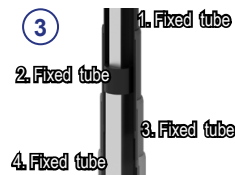

Tubes

④



Transport lock

⑤



PE-brake

⑥



Combi bell

⑦



Coupling

⑧



Clip-pin

⑨



Bell adapter

Valve Spindle square	CD* Cover depth	Total length (L)** Spindle extension	Article No.	Weight
Service Valve SQ12	0.65 - 1.00 m	0.39 - 0.74 m	21024	2.1 kg
	1.00 - 1.80 m	0.73 - 1.52 m	21069	3.4 kg

*Cover depth measurements depend on the height of the valve used, see p. 11.

**Other lengths available upon request.

scan me!



Subject to technical modifications!

Telescopic spindle extension T3



1 Square cap SQ12/14



2 Centring cap

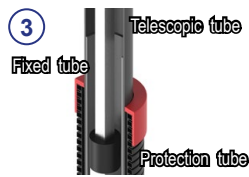

3 Tubes

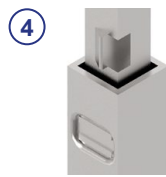

4 Transport lock



5 PE-brake



6 Combi bell



7 Coupling



8 Clip-pin

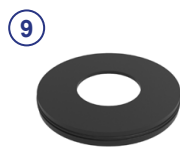

9 Bell adapter

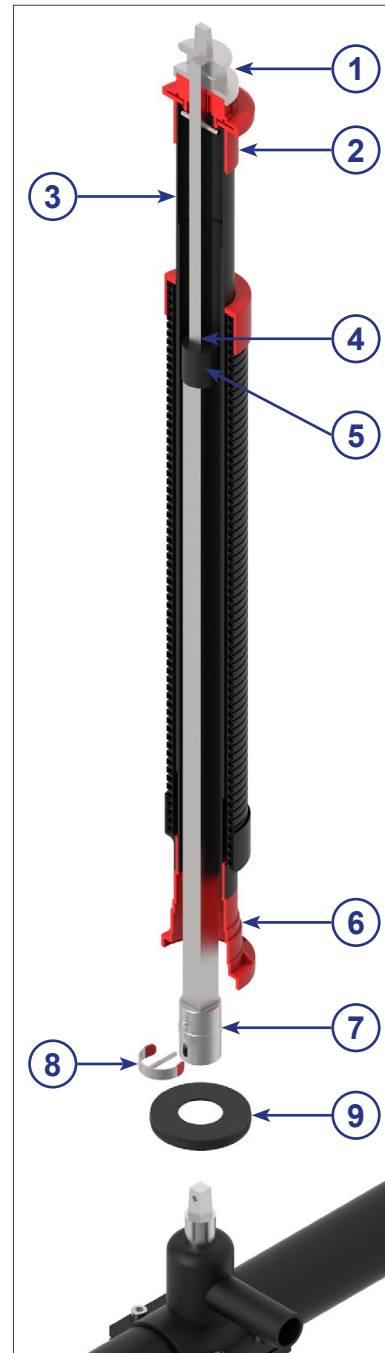

Valve Spindle square	CD* Cover depth	Total length (L)** Spindle extension	Article No.	Weight	PU
Service Valve SQ12	0.70 - 1.00 m	0.47 - 0.73 m	10088.T3	2.0 kg	100
	0.85 - 1.30 m	0.62 - 1.02 m	14004.T3	2.5 kg	100
	1.00 - 1.50 m	0.78 - 1.33 m	14005.T3	3.0 kg	70
	1.25 - 1.80 m	0.93 - 1.63 m	14006.T3	3.5 kg	70
	1.50 - 2.00 m	1.03 - 1.80 m	14007.T3	4.0 kg	70
	1.70 - 2.70 m	1.42 - 2.38 m	14094.T3	5.0 kg	-

PU = Deliveries only possible in packaging units!

*Cover depth measurements depend on the height of the valve used, see p. 11.

**Other lengths available upon request.

Subject to technical modifications!

scan me!



Telescopic spindle extension T3 DVGW GW336

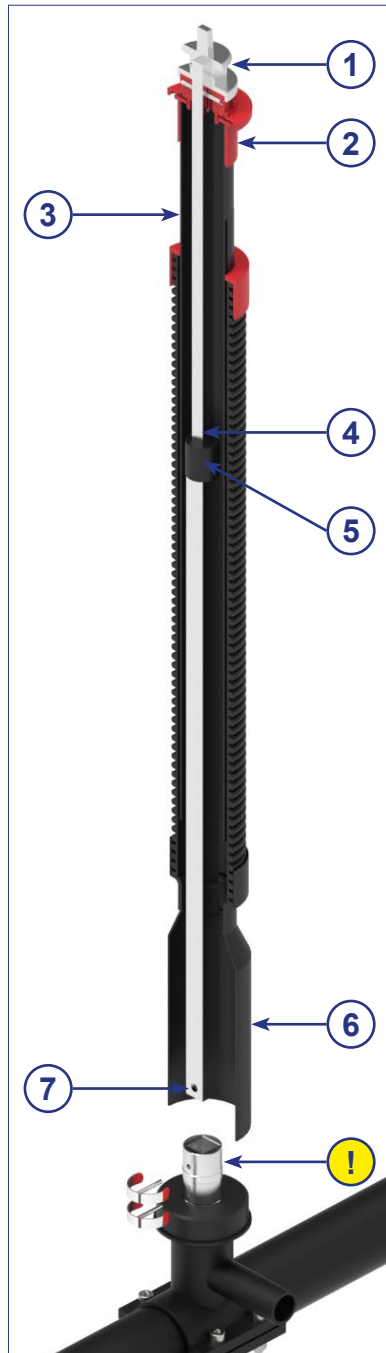

①



Square cap SQ12/14
as per DVGW GW336

②



Centring cap

③



Telescopic tube

Fixed tube

Protection tube

Tubes

④



Transport lock 150N
as per DVGW GW336

⑤



PE-brake

⑥



Round bell
as per DVGW GW336

⑦



Square bar with
drilling as per
DVGW GW336

!

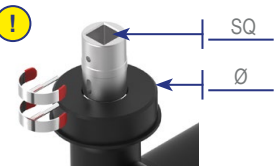

Adapter set p.35
(optional)

Valve	Operating head	Connection to coupling	Total length (L)* Spindle extension	Type 1 (140 Nm)		Type 2 (100 Nm)	
				Article No.	Weight	Article No.	Weight
Service valve DN ≤ 50 Ball valve DN ≤ 50	DIN 3223 E	SQ20x20 mm Ø80 mm	0.40 - 0.65 m	13997.GW336	1.4 kg	13997.01.GW336	1.4 kg
			0.65 - 1.15 m	14008.GW336	2.6 kg	14008.01.GW336	2.2 kg
			0.80 - 1.45 m	14009.GW336	3.4 kg	14009.01.GW336	2.9 kg
			0.90 - 1.55 m	14010.GW336	3.7 kg	14010.01.GW336	3.1 kg
			1.37 - 2.45 m	14089.GW336	5.1 kg	14089.01.GW336	4.4 kg

*Other lengths available upon request.

Telescopic spindle extensions are as per the DVGW worksheet GW336-1 (A) (09/2010)
Testing as per DVGW test schedule GW336-2 (P) (09/2010)

scan me!



Subject to technical modifications!

Telescopic spindle extension T3 - stainless steel



Centring cap



Tubes

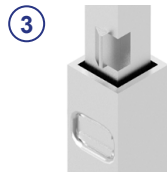

Transport lock



PE-brake



Combi bell



Coupling



Clip-pin



Bell adapter

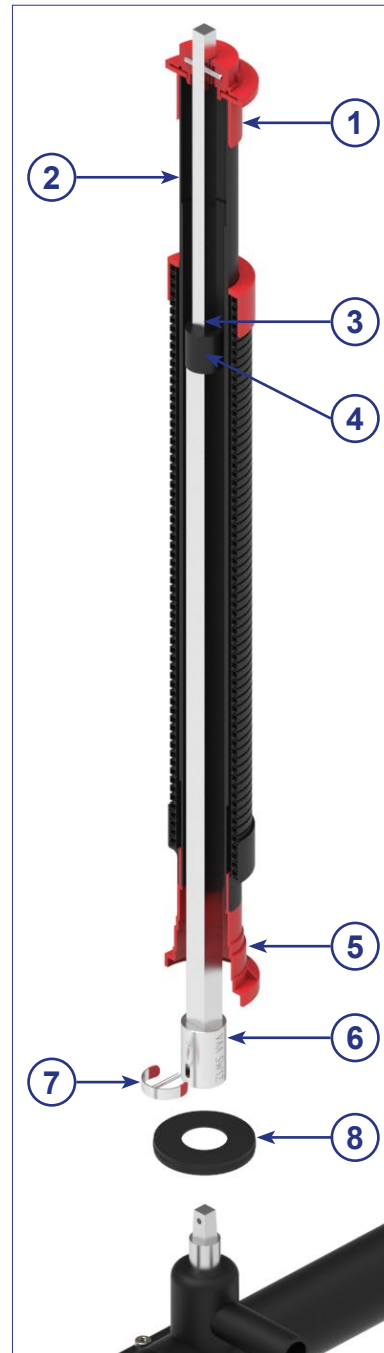

Valve Spindle square	CD* Cover depth	Total length (L)** Spindle extension	Article No.	Weight
Service valve SQ12	0.55 - 0.70 m	0.28 - 0.41 m	14095.VA	1.3 kg
	0.70 - 1.00 m	0.43 - 0.69 m	10088.VA	1.7 kg
	0.85 - 1.30 m	0.58 - 0.98 m	14004.VA	2.3 kg
	1.00 - 1.50 m	0.78 - 1.31 m	14005.VA	2.8 kg
	1.25 - 1.80 m	0.89 - 1.59 m	14006.VA	3.4 kg
	1.50 - 2.00 m	0.99 - 1.76 m	14007.VA	3.6 kg
	1.70 - 2.70 m	1.38 - 2.34 m	14094.VA	4.9 kg

*Cover depth measurements depend on the height of the valve used, see p. 11.

**Other lengths available upon request.

Subject to technical modifications!

scan me!



SPINDLE EXTENSIONS FOR SERVICE VALVES

Telescopic spindle extension T2

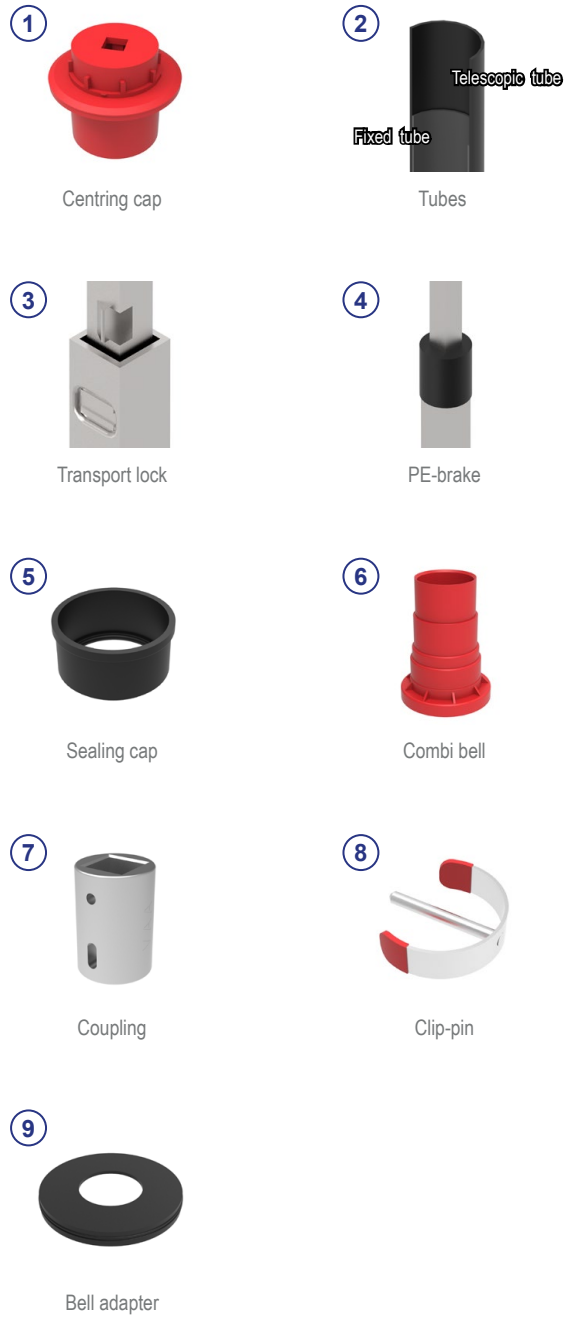
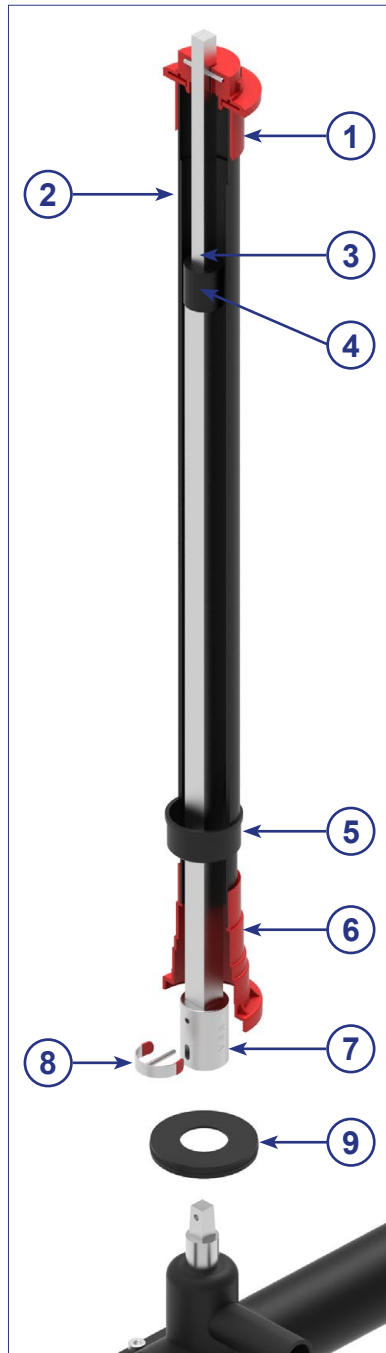

Valve Spindle square	CD* Cover depth	Total length (L)** Spindle extension	Article No.	Weight	PU
Service valve SQ12	0.55 - 0.70 m	0.28 - 0.41 m	14095.01	1.1 kg	100
	0.70 - 1.00 m	0.43 - 0.69 m	10088.01	1.5 kg	100
	0.85 - 1.30 m	0.58 - 0.98 m	14004.01	2.0 kg	100
	1.00 - 1.50 m	0.78 - 1.31 m	14005.01	2.4 kg	100
	1.25 - 1.80 m	0.89 - 1.59 m	14006.01	2.9 kg	100
	1.50 - 2.00 m	0.99 - 1.76 m	14007.01	3.1 kg	50
	1.70 - 2.70 m	1.38 - 2.34 m	14094.01	4.3 kg	50

PU = Deliveries only possible in pack units!

*Cover depth measurements depend on the height of the valve used, see p. 11.

**Other lengths available upon request.

Subject to technical modifications!

scan me!



SPINDLE EXTENSIONS FOR SERVICE VALVES

Adjustable spindle extension

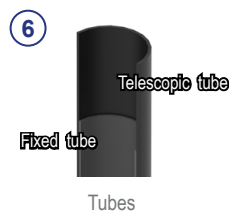

Valve Spindle square	CD* Cover depth	Total length (L)** Spindle extension	Protection tube		Spindle extension		Complete	
			Article No.	Weight	Article No.	Weight	Article No.	Weight
Service valve SQ12	0.55 - 0.70 m	0.28 - 0.41 m	15023	0.2 kg	15025	0.9 kg	15027	1.1 kg
	0.70 - 1.00 m	0.43 - 0.69 m	15024	0.3 kg	15026	1.2 kg	15028	1.5 kg
	0.85 - 1.30 m	0.58 - 0.98 m	13814	0.4 kg	13820	1.6 kg	13826	2.0 kg
	1.00 - 1.50 m	0.78 - 1.31 m	12056	0.5 kg	12059	1.9 kg	12051	2.4 kg
	1.25 - 1.80 m	0.89 - 1.59 m	12057	0.6 kg	12054	2.3 kg	12052	2.9 kg
	1.50 - 2.00 m	0.99 - 1.76 m	12058	0.6 kg	12055	2.5 kg	12053	3.1 kg
	1.70 - 2.70 m	1.38 - 2.34 m	14048	0.8 kg	14042	3.5 kg	14036	4.3 kg

*Cover depth measurements depend on the height of the valve used, see p. 11.

**Other lengths available upon request.

Subject to technical modifications!



SPINDLE EXTENSIONS FOR SERVICE VALVES

Telescopic spindle extension T2-GREEN

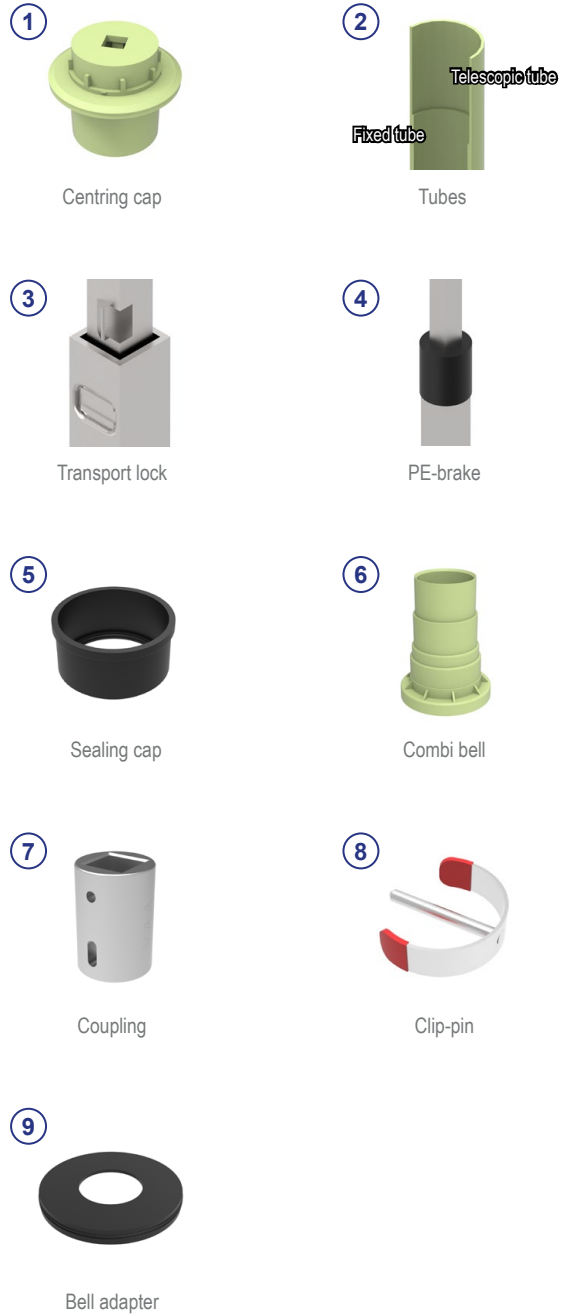
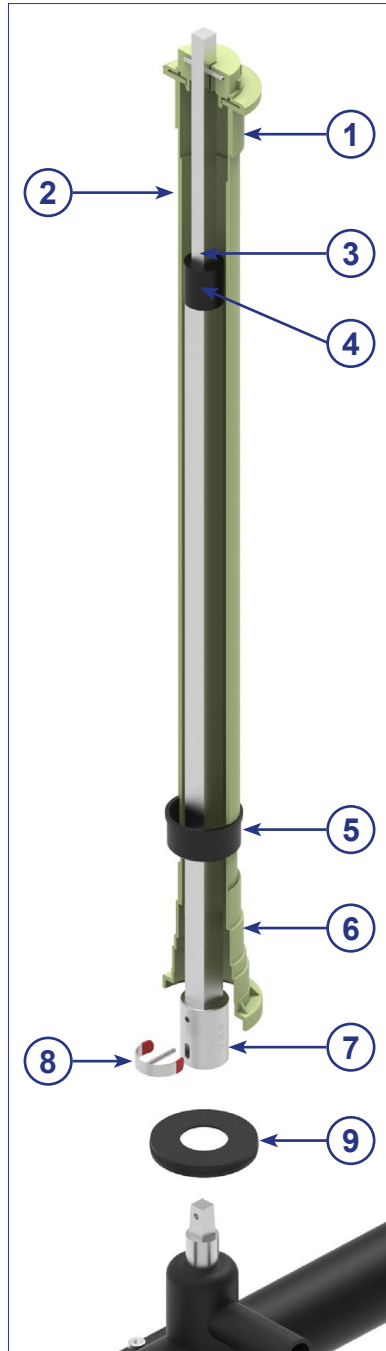

Valve Spindle square	CD* Cover depth	Total length (L)** Spindle extension	Article No.	Weight
Service valve SQ12	0.55 - 0.70 m	0.28 - 0.41 m	14095.01.BIO	1.1 kg
	0.70 - 1.00 m	0.43 - 0.69 m	10088.01.BIO	1.5 kg
	0.85 - 1.30 m	0.58 - 0.98 m	14004.01.BIO	2.0 kg
	1.00 - 1.50 m	0.78 - 1.31 m	14005.01.BIO	2.4 kg
	1.25 - 1.80 m	0.89 - 1.59 m	14006.01.BIO	2.9 kg
	1.50 - 2.00 m	0.99 - 1.76 m	14007.01.BIO	3.1 kg
	1.70 - 2.70 m	1.38 - 2.34 m	14094.01.BIO	4.3 kg

*Cover depth measurements depend on the height of the valve used, see p. 11.

**Other lengths available upon request.

Subject to technical modifications!



Telescopic spindle extension T2-GREEN



Conventional polyethylene is made from fossil raw materials such as crude oil or natural gas. However, ethanol from sugar cane is used to produce the bio-based PE-HD. Sugarcane is a fast-growing, sturdy plant that captures CO₂ from the atmosphere during its annual growth cycle. This not only saves fossil raw materials that are becoming increasingly scarce, but also helps to reduce CO₂ emissions. Depending on the Green PE type, the percentage of renewable carbon is between 80% and 100%, according to the ASTM D6866 standard.

*Cover depth measurements depend on the height of the valve used, see p. 11.

**Other lengths available upon request.

Subject to technical modifications!



SPINDLE EXTENSIONS FOR SERVICE VALVES

Rigid spindle extension - Square Bar -

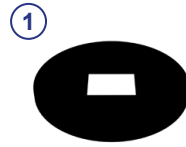
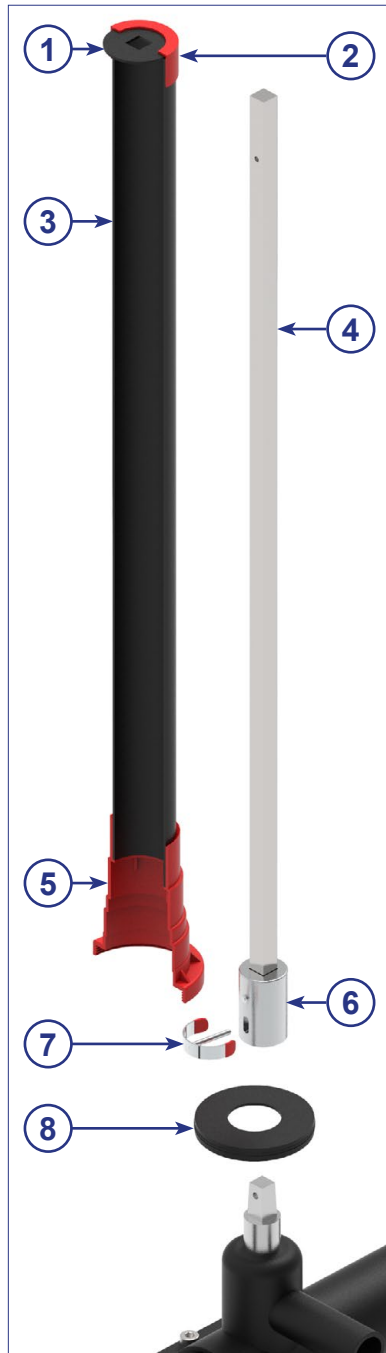

Centring disc



Covering cap



Tube

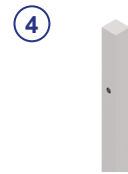

Square steel



Combi bell



Coupling



Clip-pin



Bell adapter

Valve Spindle square	CD* Cover depth	Total length (L)** Spindle extension	Protection tube		Square bar		Complete	
			Article No.	Weight	Article No.	Weight	Article No.	Weight
Service valve SQ12	0.75 m	0.49 m	11981.04	0.2 kg	11982.04	0.9 kg	11983.04	1.1 kg
	1.00 m	0.74 m	11997.04	0.2 kg	11994.04	1.3 kg	11991.04	1.5 kg
	1.25 m	0.99 m	11998.04	0.3 kg	11995.04	1.6 kg	11992.04	1.9 kg
	1.50 m	1.18 m	11999.04	0.4 kg	11996.04	1.8 kg	11993.04	2.2 kg
	2.00 m	1.74 m	14096.04	0.5 kg	14097.04	2.6 kg	14089.04	3.1 kg

*Cover depth measurements depend on the height of the valve used, see p. 11.

**Other lengths available upon request.

scan me!



Subject to technical modifications!

Rigid spindle extension - Round Bar -

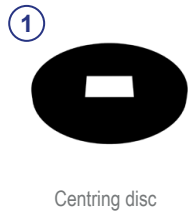

Valve Spindle square	CD* Cover depth	Total length (L)** Spindle extension	Protection tube		Round bar		Complete	
			Article No.	Weight	Article No.	Weight	Article No.	Weight
Service valve SQ12	1.00 m	0.74 m	11997	0.2 kg	11994	1.4 kg	11991	1.7 kg
	1.25 m	0.99 m	11998	0.3 kg	11995	1.8 kg	11992	2.1 kg
	1.50 m	1.18 m	11999	0.4 kg	11996	2.1 kg	11993	2.5 kg

*Cover depth measurements depend on the height of the valve used, see p. 11.
**Other lengths available upon request.



SPIND



SPINDLE EXTENSIONS FOR GATE VALVES

TABLE OF CONTENTS

Telescopic spindle extension T4X	26 - 27
Telescopic spindle extension T4	28 - 29
Telescopic spindle extension T4 DVGW GW336	30 - 31
Telescopic spindle extension T3	32 - 33
Telescopic spindle extension T3 DVGW GW336	34 - 35
Telescopic spindle extension T3 - stainless steel	36 - 37
Telescopic spindle extension T3 with position indicator	38 - 39
Telescopic spindle extension T2	40 - 41
Telescopic spindle extension T2-GREEN	42 - 43
Adjustable spindle extension	44 - 45
Rigid spindle extension - Square Bar -	46 - 47
Rigid spindle extension - Round Bar -	48 - 49

SPINDLE EXTENSIONS FOR GATE VALVES

Telescopic spindle extension T4X

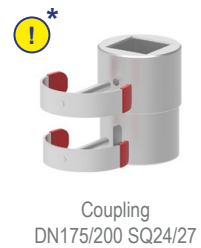
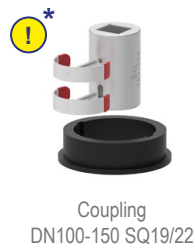
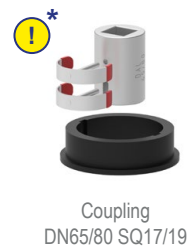
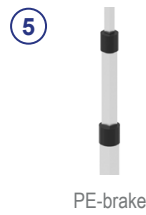
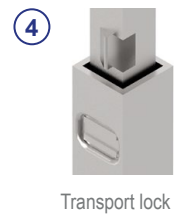
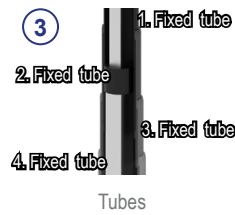
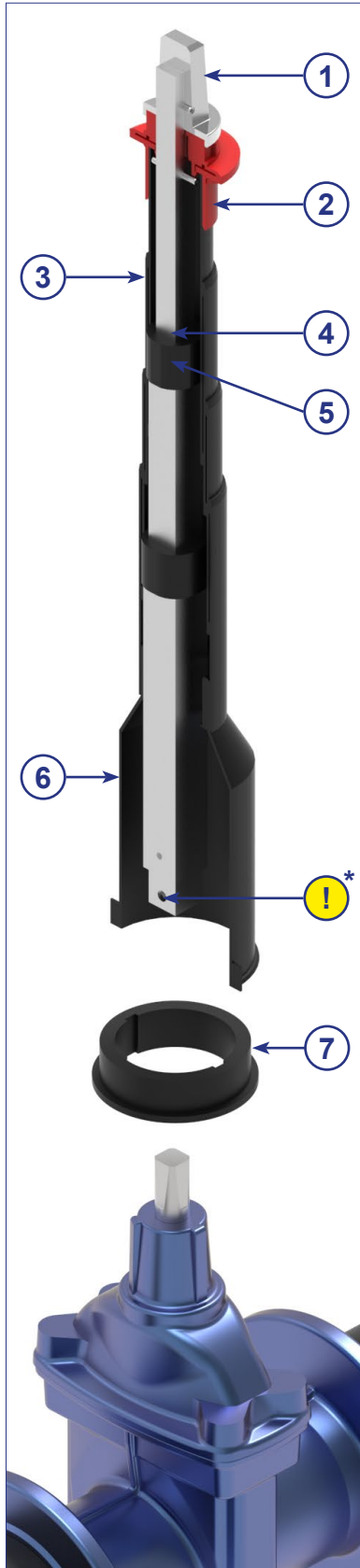

*The required couplings and bell adapter can be found on p. 27 below „Accessories suitable for Telescopic spindle extension T4X“.



SPINDLE EXTENSIONS FOR GATE VALVES

Telescopic spindle extension T4X

Valve Spindle square	CD* Cover depth	Total length (L)** Spindle extension	Article No.	Weight
Gate valve DN40/50 SQ14	0.80 - 1.15 m	0.47 - 0.82 m	22323	2.5 kg
Gate valve DN65/80 SQ17	0.85 - 1.20 m			
Gate valve DN100-150 SQ19	0.90 - 1.25 m			
Gate valve DN200 SQ24	1.00 - 1.40 m			
Gate valve DN250/300 SQ27	1.20 - 1.50 m			
Gate valve DN40/50 SQ14	0.95 - 1.85 m	0.67 - 1.54 m	22324	4.0 kg
Gate valve DN65/80 SQ17	1.00 - 1.90 m			
Gate valve DN100-150 SQ19	1.10 - 1.95 m			
Gate valve DN200 SQ24	1.20 - 2.00 m			
Gate valve DN250/300 SQ27	1.30 - 2.10 m			



Accessories suitable for Telescopic spindle extension T4X

Couplings					
Description	Valve	SQ	Article No.	Material	Weight
Coupling incl. 2xClip-pins and bell adapter Ø100 mm	DN40/50	14/17 mm	12138.00-VK-VZ	GJS-400-15 VZ	0.8 kg
	DN65/80	17/19 mm	12332.00-VK-VZ	GJS-400-15 VZ	0.6 kg
	DN100-150	19/22 mm	12333.00-VK-VZ	GJS-400-15 VZ	0.8 kg
Coupling incl. 2xClip-pins	DN175/200	24/27 mm	12140.25-VK-VZ	GJS-400-15 VZ	0.8 kg
	DN250-300	27/32 mm	12131.25-VK-GE	GJS-400-15 VZ	1.3 kg



Coupling for extension with set screw					
Description	Valve	SQ	Article No.	Material	Weight
Coupling for extension	DN250-300	27/32 mm	12131.25-VK-GE	GJS-400-15 VZ	1.3 kg



Bell adapter			
Description	Valve	Article No.	Weight
Bell adapter Ø100 mm	Ø80 mm	22941	0.03 kg



Bell adapter for extension			
Description	Diameter	Article No.	Weight
Bell adapter for extension	Ø100 mm	12514.14	0.06 kg



SPINDLE EXTENSIONS FOR GATE VALVES

Telescopic Spindle Extension T4

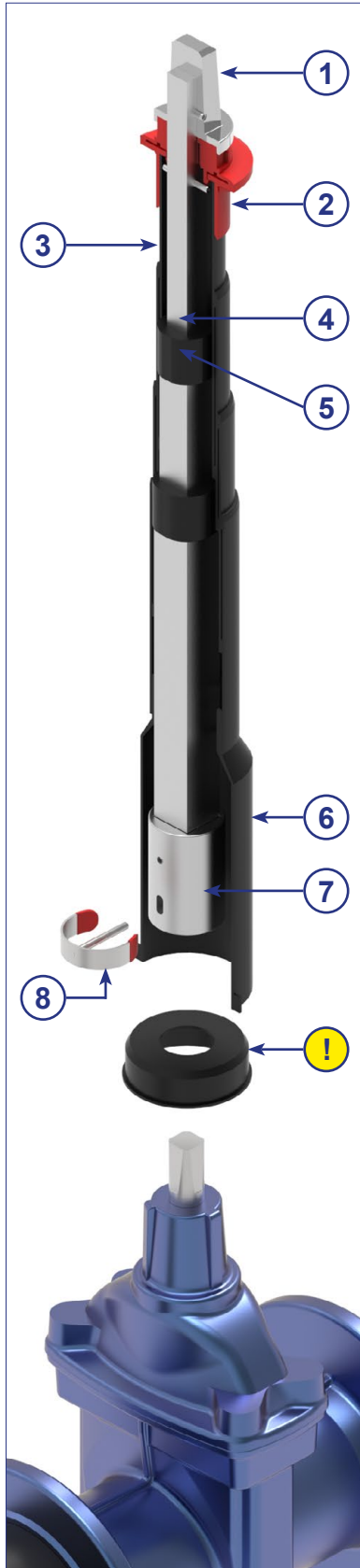

Square cap SQ27/32



Centring cap



Tubes



Transport lock

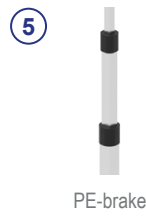

PE-brake



Round bell



Coupling



Clip-pin

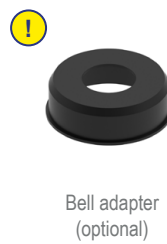

Bell adapter (optional)



Telescopic Spindle Extension T4

Valve Spindle square	CD* Cover depth	Total length (L)** Spindle extension	Article No.	Weight
Gate valve DN40/50 SQ14	0.80 - 1.15 m	0,47 - 0,82 m	21025	3.4 kg
Gate valve DN65/80 SQ17	0,85 - 1.20 m	0,47 - 0,82 m	21026	3.6 kg
Gate valve DN100-150 SQ19	0.90 - 1.25 m	0,47 - 0,82 m	21027	3.5 kg
Gate valve DN200 SQ24	0.90 - 1.25 m	0,39 - 0,74 m	22879	3.5 kg
Gate valve DN250-350 SQ27	1.01 - 1.36 m	0,39 - 0,74 m	22880	3.6 kg
Gate valve DN40/50 SQ14	0.95 - 1.85 m	0.67 - 1.54 m	21198	4.6 kg
Gate valve DN65/80 SQ17	1.00 - 1.90 m		21199	5.3 kg
Gate valve DN100-150 SQ19	1.10 - 1.95 m		21200	5.1 kg
Gate valve DN200 SQ24	1.18 - 2.05 m		22877	5.2 kg
Gate valve DN250-350 SQ27	1.29 - 2.16 m		22878	5.2 kg

*Cover depth measurements depend on the height of the valve used, see p. 11.

**Other lengths available upon request.



Subject to technical modifications!

Telescopic Spindle Extension T4 as per DVGW GW336

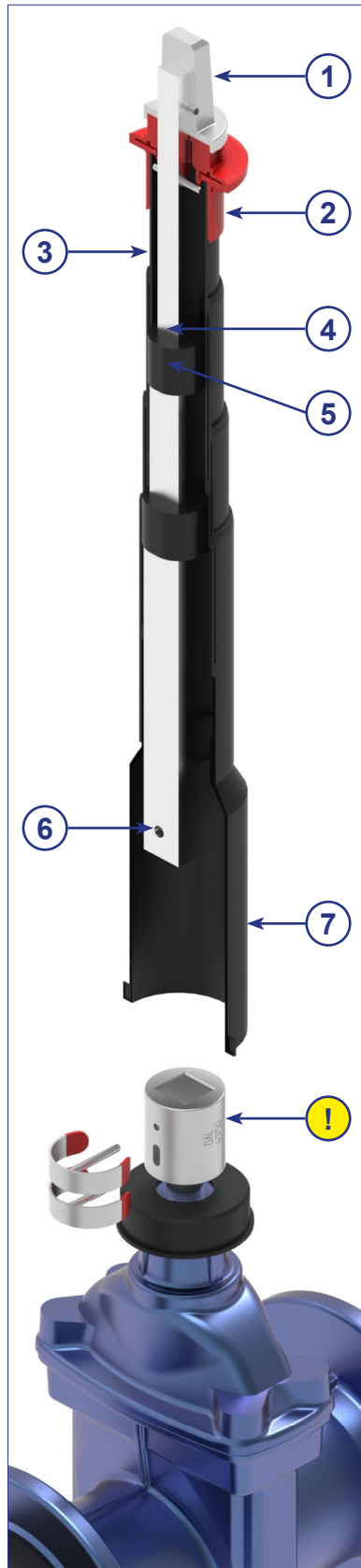

① Square cap SQ27/32
as per DVGW GW336



② Centring cap

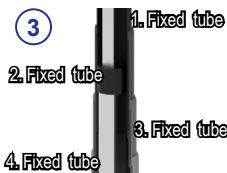

Tubes



④ Transport lock 150N
as per DVGW GW336

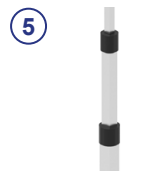

⑤ PE-brake



⑥ Square bar with drilling
as per DVGW GW336



⑦ Round bell
as per DVGW GW336

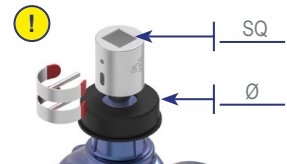

Adapter see p.31
(optional)

scan me!



Telescopic Spindle Extension T4 as per DVGW GW336



Valve	Operating head	Connection to coupling	Total length (L)* Spindle extension	Article No.	Weight
Gate valve 40 ≤ DN ≤ 150	DIN 3223 C	SQ25x25 mm Ø80 mm	0.39 - 0.74 m	21195	2.6 kg
Ball valve 65 ≤ DN ≤ 1000			0.67 - 1.54 m	21196	4.4 kg
Butterfly valve 100 ≤ DN ≤ 1000					
Gate valve 200 ≤ DN ≤ 350	DIN 3223 C	SQ30x30 mm Ø100 mm	0.39 - 0.74 m	22321	2.7 kg
			0.67 - 1.54 m	22322	4.5 kg

*Other lengths available upon request.

Adapter set for System DVGW GW336

Version	Coupling	Bell adapter	Article No.	Weight
Coupling 2xClip-pins Valve adapter universal	DN40/50 (SQ14)	Ø80 mm	13997.GW336A	1.8 kg
	DN65/80 (SQ17)	Ø80 mm	13998.GW336A	2.9 kg
	DN100-150 (SQ19)	Ø80 mm	13999.GW336A	3.7 kg
	DN175/200 (SQ24)	Ø100 mm	14017.GW336A	3.4 kg
	DN250-350 (SQ27)	Ø100 mm	14020.GW336A	6.3 kg



Telescopic Spindle Extension T3

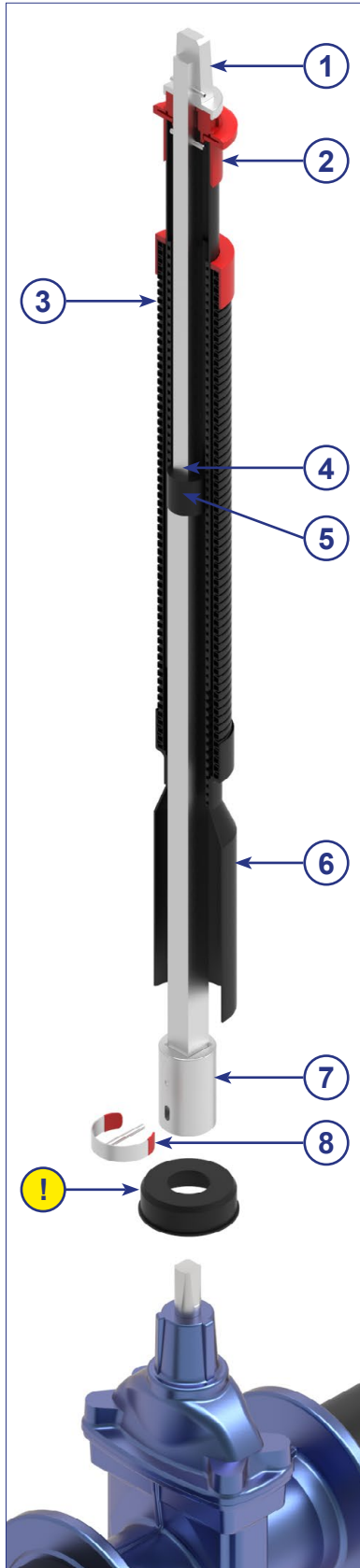

① Square cap SQ27/32



② Centring cap



Tubes

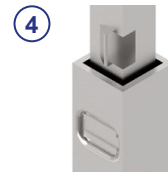

④ Transport lock

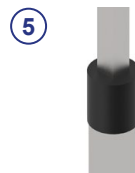

⑤ PE-brake



⑥ Round bell



⑦ Coupling



⑧ Clip-pin



⑨ Bell adapter (optional)

scan me!



SPINDLE EXTENSIONS FOR GATE VALVES

Telescopic Spindle Extension T3



Valve Spindle square	CD* Cover depth	Total length (L)** Spindle extension	Article No.	Weight	PU
Gate valve DN40/50 SQ14	1.00 - 1.50 m	0.70 - 1.20 m	14008.T3	4.2 kg	70
	1.25 - 1.80 m	0.93 - 1.61 m	14009.T3	5.3 kg	70
	1.50 - 2.00 m	1.03 - 1.82 m	14010.T3	5.8 kg	70
	1.70 - 2.70 m	1.40 - 2.56 m	14089.T3	7.6 kg	-
	2.30 - 3.90 m	1.92 - 3.60 m	15901.T3	10.0 kg	-
Gate valve DN65/80 SQ17	1.00 - 1.50 m	0.69 - 1.14 m	14011.T3	4.2 kg	70
	1.25 - 1.80 m	0.85 - 1.45 m	14012.T3	5.0 kg	70
	1.50 - 2.00 m	0.95 - 1.65 m	14013.T3	5.4 kg	70
	1.70 - 2.70 m	1.32 - 2.41 m	14090.T3	7.3 kg	-
	2.30 - 3.90 m	1.92 - 3.60 m	15902.T3	10.2 kg	-
Gate valve DN100-150 SQ19	1.00 - 1.20 m	0.54 - 0.84 m	14099.T3	3.3 kg	100
	1.20 - 1.50 m	0.64 - 1.05 m	14014.T3	4.0 kg	70
	1.25 - 1.80 m	0.80 - 1.40 m	14015.T3	4.7 kg	70
	1.50 - 2.00 m	0.95 - 1.64 m	14016.T3	5.3 kg	70
	1.70 - 2.70 m	1.30 - 2.41 m	14091.T3	7.1 kg	-
	2.30 - 3.90 m	1.92 - 3.60 m	15903.T3	10.0 kg	-
Gate valve DN175/200 SQ24	1.10 - 1.30 m	0.52 - 0.79 m	14017.T3	4.5 kg	80
	1.25 - 1.80 m	0.77 - 1.25 m	14018.T3	6.0 kg	70
	1.50 - 2.00 m	0.86 - 1.46 m	14019.T3	6.7 kg	70
	1.70 - 2.70 m	1.21 - 2.19 m	14092.T3	9.5 kg	-
	2.50 - 3.50 m	1.80 - 2.80 m	15904.T3	12.0 kg	-
Gate valve DN250-350 SQ27	1.10 - 1.30 m	0.50 - 0.80 m	14020.T3	4.5 kg	80
	1.25 - 1.80 m	0.71 - 1.15 m	14021.T3	5.7 kg	70
	1.50 - 2.00 m	0.86 - 1.45 m	14023.T3	6.8 kg	70
	1.70 - 2.70 m	1.16 - 2.05 m	14093.T3	8.9 kg	-
	2.50 - 3.50 m	1.96 - 3.16 m	15905.T3	14.6 kg	-
Gate valve DN400/450 SQ32	Telescopic version: max. torque 500 Nm				
	1.40 - 1.60 m	0.56 - 0.84 m	15017.T3	7.2 kg	-
	1.60 - 2.05 m	0.76 - 1.22 m	15018.T3	8.5 kg	-
	2.00 - 2.90 m	1.20 - 2.09 m	15019.T3	11.6 kg	-
	2.50 - 3.50 m	1.80 - 3.00 m	15906.T3	15.1 kg	-
Gate valve DN500/600 SQ36	Telescopic version: max. torque 500 Nm				
	1.45 - 1.65 m	0.53 - 0.76 m	15021.T3	8.1 kg	-
	1.65 - 2.10 m	0.75 - 1.16 m	15050.T3	9.5 kg	-
	2.10 - 2.70 m	1.13 - 1.86 m	15022.T3	11.8 kg	-
	2.50 - 3.50 m	1.80 - 2.80 m	15907.T3	16.1 kg	-

PU = Deliveries only possible in packaging units!

*Cover depth measurements depend on the height of the valve used, see p. 11.

**Other lengths available upon request.

Telescopic Spindle Extension T3 as per DVGW GW336

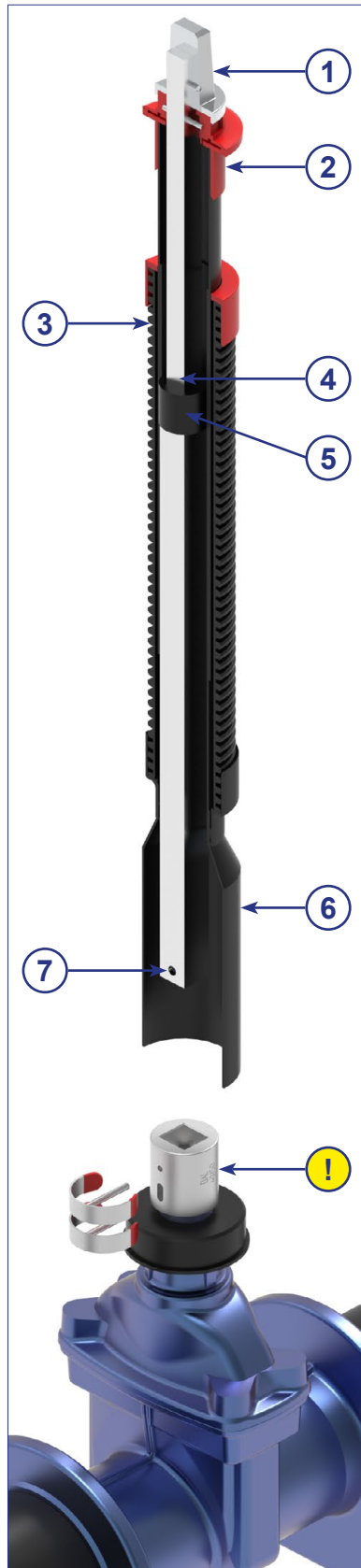

① Square cap SQ27/32 as per DVGW GW336



② Centring cap



Tubes



④ Transport lock 150N as per DVGW GW336



⑤ PE-brake



⑥ Round bell as per DVGW GW336



⑦ Square bar with drilling as per DVGW GW336

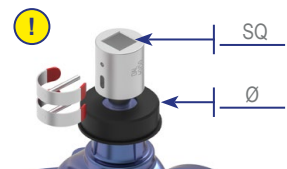

Adapter see p.35 (optional)

scan me!



Telescopic Spindle Extension T3 as per DVGW GW336



Valves	Operating head	Connection to coupling	Total length (L)* Spindle extension	Article No.	Weight
Gate valve 40 ≤ DN ≤ 150 Ball valve 65 ≤ DN ≤ 1000 Butterfly valve 100 ≤ DN ≤ 1000	DIN 3223 C	SQ25x25 mm Ø80 mm	0.36 - 0.56 m	13999.GW336	2.0 kg
			0.60 - 1.01 m	14014.GW336	3.1 kg
			0.76 - 1.36 m	14015.GW336	3.9 kg
			0.91 - 1.60 m	14016.GW336	4.5 kg
			1.26 - 2.36 m	14091.GW336	6.4 kg
Gate valve 200 ≤ DN ≤ 350	DIN 3223 C	SQ30x30 mm Ø100 mm	0.33 - 0.40 m	13565.GW336	2.6 kg
			0.49 - 0.76 m	14017.GW336	3.6 kg
			0.74 - 1.22 m	14018.GW336	5.1 kg
			0.82 - 1.42 m	14019.GW336	5.8 kg
			1.17 - 2.12 m	14092.GW336	8.6 kg

*Other lengths available upon request.

Telescopic spindle extensions are as per the DVGW worksheet GW336-1 (A) (09/2010)
Testing as per DVGW test schedule GW336-2 (P) (09/2010)

Adapter set for System DVGW GW336

Version	Coupling	Bell adapter	Article No.	Weight
Coupling 2xClip-pins Valve adapter universal	Service valve	Ø80 mm	14004.GW336A	0.3 kg
	DN40/50 (SQ14)	Ø80 mm	13997.GW336A	1.8 kg
	DN65/80 (SQ17)	Ø80 mm	13998.GW336A	2.9 kg
	DN100-150 (SQ19)	Ø80 mm	13999.GW336A	3.7 kg
	DN175/200 (SQ24)	Ø100 mm	14017.GW336A	3.4 kg
	DN250-350 (SQ27)	Ø100 mm	14020.GW336A	6.3 kg



Telescopic Spindle Extension T3 - Stainless steel

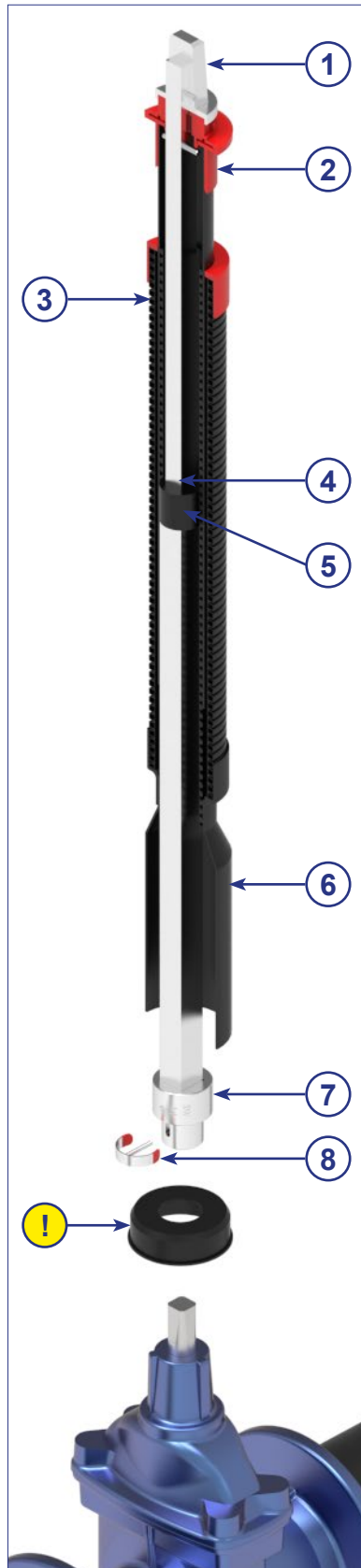

① Square cap SQ27/32



② Centring cap



Tubes

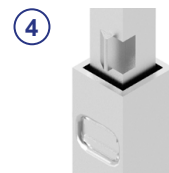

④ Transport lock



⑤ PE-brake



⑥ Round bell



⑦ Coupling



⑧ Clip-pin



⑨ Bell adapter (optional)



scan me!



Telescopic Spindle Extension T3 - Stainless steel



Valve Spindle square	CD* Cover depth	Total length (L)** Spindle extension	Article No.	Weight
Gate valve DN40/50 SQ14	0.75 - 1.00 m	0.47 - 0.70 m	13997.VA	3.0 kg
	1.00 - 1.50 m	0.70 - 1.20 m	14008.VA	4.1 kg
	1.25 - 1.80 m	0.93 - 1.61 m	14009.VA	5.2 kg
	1.50 - 2.00 m	1.03 - 1.82 m	14010.VA	5.6 kg
	1.70 - 2.70 m	1.40 - 2.56 m	14089.VA	7.5 kg
	2.30 - 3.90 m	1.92 - 3.60 m	15901.VA	10.0 kg
Gate valve DN65/80 SQ17	0.85 - 1.00 m	0.45 - 0.67 m	13998.VA	3.1 kg
	1.00 - 1.50 m	0.69 - 1.14 m	14011.VA	4.3 kg
	1.25 - 1.80 m	0.85 - 1.45 m	14012.VA	5.0 kg
	1.50 - 2.00 m	0.95 - 1.65 m	14013.VA	5.5 kg
	1.70 - 2.70 m	1.32 - 2.41 m	14090.VA	7.4 kg
	2.30 - 3.90 m	1.92 - 3.60 m	15902.VA	10.3 kg
Gate valve DN100-150 SQ19	0.80 - 0.95 m	0.40 - 0.58 m	13999.VA	3.0 kg
	1.00 - 1.20 m	0.54 - 0.84 m	14099.VA	3.5 kg
	1.20 - 1.50 m	0.64 - 1.05 m	14014.VA	4.2 kg
	1.25 - 1.80 m	0.80 - 1.40 m	14015.VA	5.0 kg
	1.50 - 2.00 m	0.95 - 1.64 m	14016.VA	5.5 kg
	1.70 - 2.70 m	1.30 - 2.41 m	14091.VA	7.4 kg
Gate valve DN175/200 SQ24	0.90 - 1.00 m	0.36 - 0.50 m	13565.VA	3.6 kg
	1.10 - 1.30 m	0.52 - 0.79 m	14017.VA	4.6 kg
	1.25 - 1.80 m	0.77 - 1.25 m	14018.VA	6.1 kg
	1.50 - 2.00 m	0.86 - 1.46 m	14019.VA	6.8 kg
	1.70 - 2.70 m	1.21 - 2.19 m	14092.VA	9.6 kg
	2.50 - 3.50 m	1.80 - 2.80 m	15904.VA	12.0 kg
Gate valve DN250-350 SQ27	1.00 - 1.10 m	0.37 - 0.49 m	14101.VA	3.4 kg
	1.10 - 1.30 m	0.55 - 0.80 m	14020.VA	4.4 kg
	1.30 - 1.80 m	0.71 - 1.15 m	14021.VA	5.7 kg
	1.50 - 2.00 m	0.86 - 1.45 m	14023.VA	6.6 kg
	1.80 - 2.70 m	1.16 - 2.05 m	14093.VA	8.8 kg
	2.50 - 3.50 m	1.96 - 3.16 m	15905.VA	14.5 kg

*Cover depth measurements depend on the height of the valve used, see p. 11.

**Other lengths available upon request.

Telescopic Spindle Extension T3 with position indicator

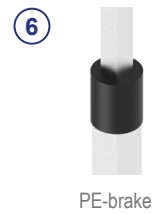
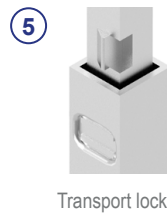
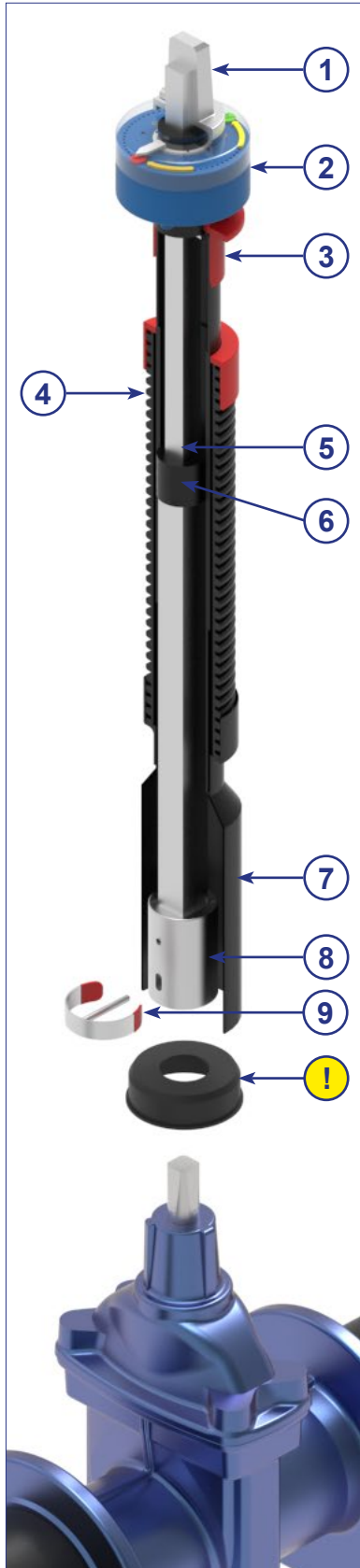

Telescopic Spindle Extension T3 with position indicator



Valve Spindle square	CD* Cover depth	Total length (L)** Spindle extension	Article No.	Weight
Gate valve DN40/50 SQ14	1.05 - 1.50 m	0.75 - 1.20 m	20291	5.4 kg
	1.30 - 1.80 m	0.98 - 1.61 m	20292	5.7 kg
	1.55 - 2.00 m	1.08 - 1.82 m	20293	6.4 kg
	1.75 - 2.70 m	1.45 - 2.56 m	20294	8.3 kg
	2.35 - 3.90 m	1.97 - 3.60 m	20295	10.7 kg
Gate valve DN65/80 SQ17	1.05 - 1.50 m	0.74 - 1.14 m	20296	5.6 kg
	1.30 - 1.80 m	0.90 - 1.45 m	20297	6.2 kg
	1.55 - 2.00 m	1.00 - 1.65 m	20298	6.7 kg
	1.75 - 2.70 m	1.37 - 2.41 m	20299	8.6 kg
	2.35 - 3.90 m	1.97 - 3.60 m	20300	11.4 kg
Gate valve DN100-150 SQ19	1.05 - 1.20 m	0.59 - 0.84 m	20301	4.6 kg
	1.25 - 1.50 m	0.69 - 1.05 m	20302	5.5 kg
	1.30 - 1.80 m	0.85 - 1.40 m	20303	5.8 kg
	1.55 - 2.00 m	1.00 - 1.64 m	20304	6.6 kg
	1.75 - 2.70 m	1.35 - 2.41 m	20305	8.4 kg
	2.35 - 3.90 m	1.97 - 3.60 m	20306	11.3 kg
Gate valve DN175/200 SQ24	1.15 - 1.30 m	0.57 - 0.79 m	20307	5.1 kg
	1.30 - 1.80 m	0.82 - 1.25 m	20308	6.6 kg
	1.55 - 2.00 m	0.91 - 1.46 m	20309	7.4 kg
	1.75 - 2.70 m	1.26 - 2.19 m	20310	10.1 kg
	2.55 - 3.50 m	1.85 - 2.80 m	20311	12.6 kg
Gate valve DN250-350 SQ27	1.15 - 1.30 m	0.55 - 0.80 m	20312	5.2 kg
	1.35 - 1.80 m	0.76 - 1.15 m	20313	6.4 kg
	1.55 - 2.00 m	0.91 - 1.45 m	20314	7.5 kg
	1.85 - 2.70 m	1.21 - 2.05 m	20315	9.6 kg
	2.55 - 3.50 m	2.01 - 3.16 m	20316	15.2 kg
Gate valve DN400/450 SQ32	1.45 - 1.60 m	0.61 - 0.84 m	20317	7.8 kg
	1.65 - 2.05 m	0.81 - 1.22 m	20318	9.1 kg
	2.05 - 2.90 m	1.25 - 2.09 m	20319	12.3 kg
	2.55 - 3.50 m	1.85 - 3.00 m	20320	15.8 kg
Gate valve DN500/600 SQ36	1.50 - 1.65 m	0.58 - 0.76 m	20321	8.8 kg
	1.70 - 2.10 m	0.80 - 1.16 m	20322	10.2 kg
	2.15 - 2.70 m	1.18 - 1.86 m	20323	12.5 kg
	2.55 - 3.50 m	1.85 - 2.80 m	20324	16.8 kg

*Cover depth measurements depend on the height of the valve used, see p. 11.

**Other lengths available upon request.

SPINDLE EXTENSIONS FOR GATE VALVES

Telescopic Spindle Extension T2

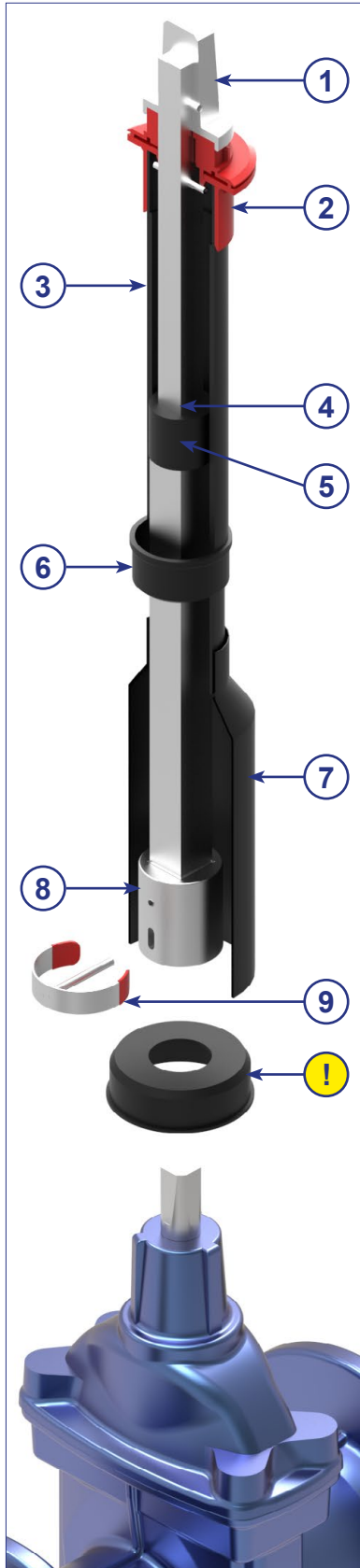

1 Square cap SQ27/32



2 Centring cap



Telescope tube

Fixed tube

Tubes

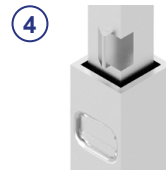

4 Transport lock



5 PE-brake



6 Sealing cap



7 Round bell



8 Coupling



9 Clip-pin



9 Bell adapter (optional)

scan me!



SPINDLE EXTENSIONS FOR GATE VALVES

Telescopic Spindle Extension T2



Valve Spindle square	CD* Cover depth	Total length (L)** Spindle extension	Article No.	Weight	PU
Gate valve DN40/50 SQ14	0.75 - 1.00 m	0.47 - 0.70 m	13997.01	2.9 kg	50
	1.00 - 1.50 m	0.70 - 1.20 m	14008.01	4.0 kg	50
	1.25 - 1.80 m	0.93 - 1.61 m	14009.01	4.7 kg	50
	1.50 - 2.00 m	1.03 - 1.82 m	14010.01	5.2 kg	50
	1.70 - 2.70 m	1.40 - 2.56 m	14089.01	6.9 kg	50
Gate valve DN65/80 SQ17	0.85 - 1.00 m	0.45 - 0.67 m	13998.01	3.0 kg	60
	1.00 - 1.50 m	0.69 - 1.14 m	14011.01	4.0 kg	60
	1.25 - 1.80 m	0.85 - 1.45 m	14012.01	4.7 kg	60
	1.50 - 2.00 m	0.95 - 1.65 m	14013.01	5.2 kg	60
	1.70 - 2.70 m	1.32 - 2.41 m	14090.01	6.9 kg	60
Gate valve DN100-150 SQ19	0.80 - 0.95 m	0.40 - 0.58 m	13999.01	2.6 kg	60
	1.00 - 1.20 m	0.54 - 0.84 m	14099.01	3.2 kg	60
	1.20 - 1.50 m	0.64 - 1.05 m	14014.01	3.8 kg	60
	1.25 - 1.80 m	0.80 - 1.40 m	14015.01	4.5 kg	60
	1.50 - 2.00 m	0.95 - 1.64 m	14016.01	5.0 kg	60
	1.70 - 2.70 m	1.30 - 2.41 m	14091.01	6.8 kg	60
Gate valve DN175/200 SQ24	0.90 - 1.00 m	0.36 - 0.44 m	13565.01	3.4 kg	10
	1.10 - 1.30 m	0.52 - 0.79 m	14017.01	4.3 kg	10
	1.25 - 1.80 m	0.77 - 1.25 m	14018.01	5.8 kg	10
	1.50 - 2.00 m	0.86 - 1.46 m	14019.01	6.5 kg	10
	1.70 - 2.70 m	1.21 - 2.19 m	14092.01	9.1 kg	10
Gate valve DN 250/350 SQ27	1.00 - 1.10 m	0.37 - 0.49 m	14101.01	3.4 kg	10
	1.10 - 1.30 m	0.50 - 0.80 m	14020.01	4.4 kg	10
	1.30 - 1.80 m	0.71 - 1.15 m	14021.01	5.5 kg	10
	1.50 - 2.00 m	0.86 - 1.45 m	14023.01	6.5 kg	10
	1.80 - 2.70 m	1.16 - 2.05 m	14093.01	8.6 kg	10

PU = Deliveries only possible in pack units!

*Cover depth measurements depend on the height of the valve used, see p. 11.

**Other lengths available upon request.

SPINDLE EXTENSIONS FOR GATE VALVES

Telescopic Spindle Extension T2-GREEN

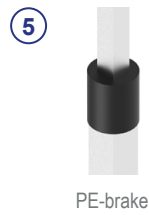
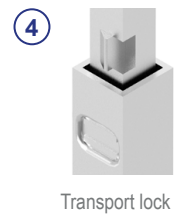
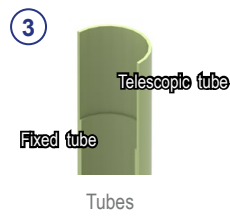
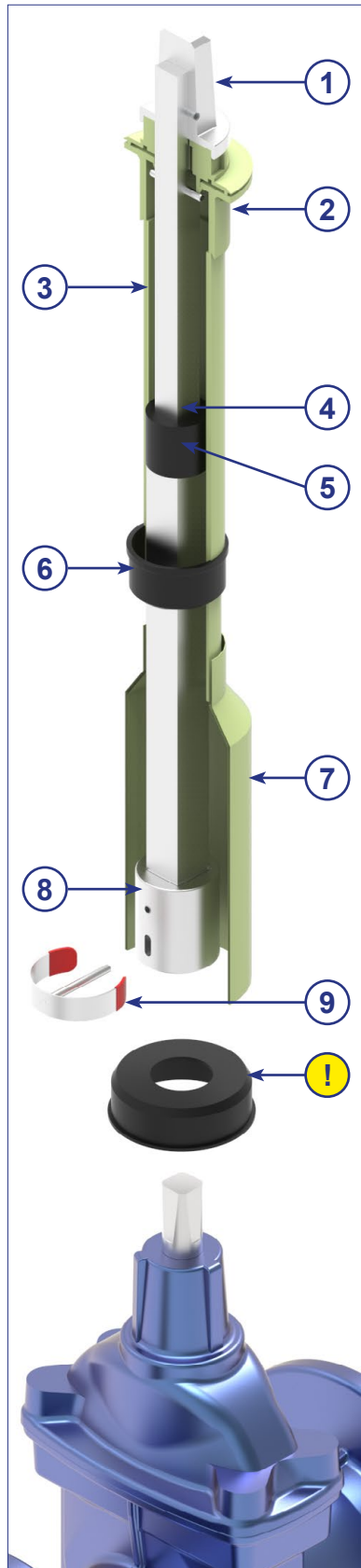

scan me!



Telescopic Spindle Extension T2-GREEN



Valve Spindle square	CD* Cover depth	Total length (L)** Spindle extension	Article No.	Weight
Gate valve DN40/50 SQ14	0.75 - 1.00 m	0.47 - 0.70 m	13997.01.BIO	2.9 kg
	1.00 - 1.50 m	0.70 - 1.20 m	14008.01.BIO	4.0 kg
	1.25 - 1.80 m	0.93 - 1.61 m	14009.01.BIO	4.7 kg
	1.50 - 2.00 m	1.03 - 1.82 m	14010.01.BIO	5.2 kg
	1.70 - 2.70 m	1.40 - 2.56 m	14089.01.BIO	6.9 kg
Gate valve DN65/80 SQ17	0.85 - 1.00 m	0.45 - 0.67 m	13998.01.BIO	3.0 kg
	1.00 - 1.50 m	0.69 - 1.14 m	14011.01.BIO	4.0 kg
	1.25 - 1.80 m	0.85 - 1.45 m	14012.01.BIO	4.7 kg
	1.50 - 2.00 m	0.95 - 1.65 m	14013.01.BIO	5.2 kg
	1.70 - 2.70 m	1.32 - 2.41 m	14090.01.BIO	6.9 kg
Gate valve DN100-150 SQ19	0.80 - 0.95 m	0.40 - 0.58 m	13999.01.BIO	2.6 kg
	1.00 - 1.20 m	0.54 - 0.84 m	14009.01.BIO	3.2 kg
	1.20 - 1.50 m	0.64 - 1.05 m	14014.01.BIO	3.8 kg
	1.25 - 1.80 m	0.80 - 1.40 m	14015.01.BIO	4.5 kg
	1.50 - 2.00 m	0.95 - 1.64 m	14016.01.BIO	5.0 kg
	1.70 - 2.70 m	1.30 - 2.41 m	14091.01.BIO	6.8 kg
Gate valve DN175/200 SQ24	0.90 - 1.00 m	0.36 - 0.44 m	13565.01.BIO	3.4 kg
	1.10 - 1.30 m	0.52 - 0.79 m	14017.01.BIO	4.3 kg
	1.25 - 1.80 m	0.77 - 1.25 m	14018.01.BIO	5.8 kg
	1.50 - 2.00 m	0.86 - 1.46 m	14019.01.BIO	6.5 kg
	1.70 - 2.70 m	1.21 - 2.19 m	14092.01.BIO	9.1 kg
Gate valve DN 250/350 SQ27	1.00 - 1.10 m	0.37 - 0.49 m	14101.01.BIO	3.4 kg
	1.10 - 1.30 m	0.50 - 0.80 m	14020.01.BIO	4.4 kg
	1.30 - 1.80 m	0.71 - 1.15 m	14021.01.BIO	5.5 kg
	1.50 - 2.00 m	0.86 - 1.45 m	14023.01.BIO	6.5 kg
	1.80 - 2.70 m	1.16 - 2.05 m	14093.01.BIO	8.6 kg

*Cover depth measurements depend on the height of the valve used, see p. 11.

**Other lengths available upon request.

Conventional polyethylene is made from fossil raw materials such as crude oil or natural gas. However, ethanol from sugar cane is used to produce the bio-based PE-HD.

Sugarcane is a fast-growing, sturdy plant that captures CO₂ from the atmosphere during its annual growth cycle. This not only saves fossil raw materials that are becoming increasingly scarce, but also helps to reduce CO₂ emissions. Depending on the Green PE type, the percentage of renewable carbon is between 80% and 100%, according to the ASTM D6866 standard.

SPINDLE EXTENSIONS FOR GATE VALVES

Adjustable Spindle Extension

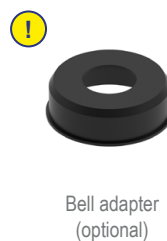
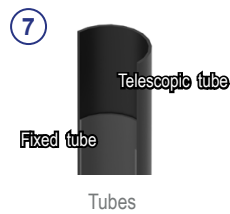
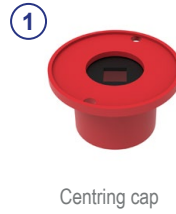
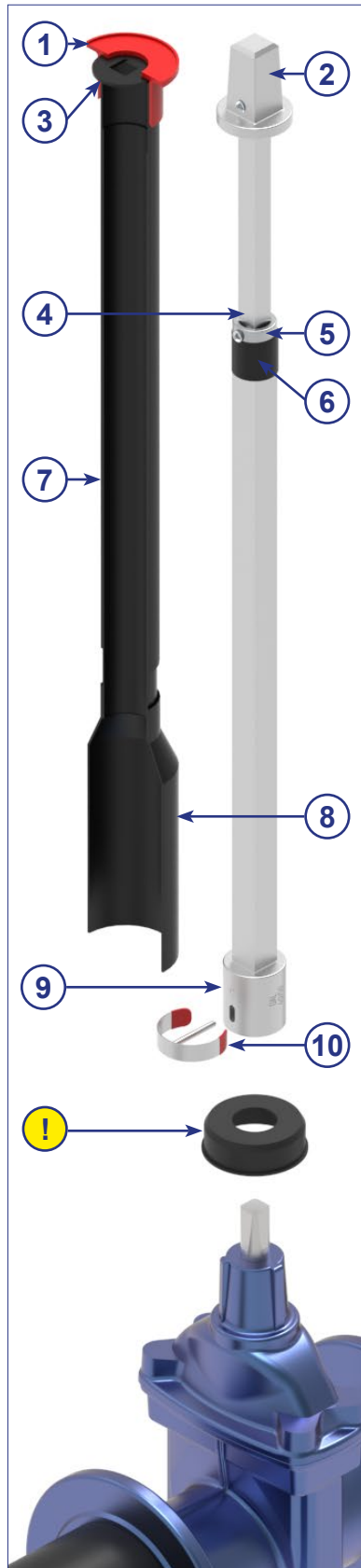

scan me!



SPINDLE EXTENSIONS FOR GATE VALVES

Adjustable Spindle Extension



Valve Spindle square	CD* Cover depth	Total length (L)** Spindle extension	Protection tube		Spindle extension		Complete	
			Article No.	Weight	Article No.	Weight	Article No.	Weight
Gate valve DN40/50 SQ14	0.75 - 1.00 m	0.47 - 0.70 m	13815	0.3 kg	13821	2.6 kg	13993	3.0 kg
	1.00 - 1.50 m	0.70 - 1.20 m	12066	0.4 kg	12065	3.6 kg	12060	4.0 kg
	1.25 - 1.80 m	0.93 - 1.61 m	12067	0.6 kg	12063	4.5 kg	12061	5.0 kg
	1.50 - 2.00 m	1.03 - 1.82 m	12068	0.6 kg	12064	4.8 kg	12062	5.4 kg
	1.70 - 2.70 m	1.40 - 2.56 m	14049	0.8 kg	14043	6.4 kg	14037	7.2 kg
	2.30 - 3.90 m	1.92 - 3.60 m	16921	1.1 kg	16901	8.4 kg	16911	9.5 kg
Gate valve DN65/80 SQ17	0.85 - 1.00 m	0.45 - 0.67 m	13816	0.3 kg	13822	2.7 kg	13994	3.0 kg
	1.00 - 1.50 m	0.69 - 1.14 m	12075	0.4 kg	12072	3.6 kg	12069	4.0 kg
	1.25 - 1.80 m	0.85 - 1.45 m	12076	0.6 kg	12073	4.2 kg	12070	4.7 kg
	1.50 - 2.00 m	0.95 - 1.64 m	12077	0.6 kg	12074	4.6 kg	12071	5.2 kg
	1.70 - 2.70 m	1.32 - 2.41 m	14050	0.8 kg	14044	6.1 kg	14038	6.9 kg
	2.30 - 3.90 m	1.92 - 3.60 m	16922	1.1 kg	16902	8.5 kg	16912	9.6 kg
Gate valve DN100-150 SQ19	0.80 - 0.95 m	0.40 - 0.58 m	13817	0.3 kg	13823	2.4 kg	13995	2.6 kg
	1.00 - 1.20 m	0.54 - 0.84 m	15061	0.3 kg	15060	2.9 kg	15059	3.2 kg
	1.20 - 1.50 m	0.64 - 1.05 m	13199	0.4 kg	12081	3.4 kg	12078	3.8 kg
	1.25 - 1.80 m	0.80 - 1.40 m	12085	0.5 kg	12082	4.0 kg	12079	4.5 kg
	1.50 - 2.00 m	0.95 - 1.64 m	12086	0.6 kg	12083	4.5 kg	12080	5.1 kg
	1.70 - 2.70 m	1.30 - 2.41 m	14051	0.8 kg	14045	6.0 kg	14039	6.8 kg
	2.30 - 3.90 m	1.92 - 3.60 m	16923	1.1 kg	16903	11.0 kg	16913	9.5 kg
Gate valve DN175/200 SQ24	0.90 - 1.00 m	0.36 - 0.44 m	15029	0.3 kg	13824	3.1 kg	13830	3.4 kg
	1.10 - 1.30 m	0.52 - 0.79 m	12093	0.4 kg	12090	4.0 kg	12087	4.4 kg
	1.25 - 1.80 m	0.77 - 1.25 m	12094	0.5 kg	12091	5.4 kg	12088	5.9 kg
	1.50 - 2.00 m	0.86 - 1.46 m	12095	0.6 kg	12092	6.0 kg	12089	6.5 kg
	1.70 - 2.70 m	1.21 - 2.19 m	14052	0.8 kg	14046	8.4 kg	14040	9.2 kg
	2.50 - 3.50 m	1.96 - 3.16 m	16924	1.1 kg	16904	11.4 kg	16914	12.6 kg
Gate valve DN 200-350 SQ27	1.00 - 1.10 m	0.37 - 0.49 m	15058	0.3 kg	15057	3.2 kg	15052	3.5 kg
	1.10 - 1.30 m	0.50 - 0.80 m	12101	0.4 kg	12098	4.1 kg	12096	4.5 kg
	1.30 - 1.80 m	0.71 - 1.15 m	12102	0.5 kg	12099	5.1 kg	12097	5.6 kg
	1.50 - 2.00 m	0.86 - 1.45 m	12103	0.5 kg	12100	6.1 kg	12104	6.6 kg
	1.80 - 2.70 m	1.16 - 2.05 m	14053	0.7 kg	14047	7.9 kg	14041	8.6 kg
	2.50 - 3.50 m	1.96 - 3.16 m	16925	1.1 kg	16905	11.4 kg	16915	12.6 kg
Gate valve DN400/450 SQ32	1.20 - 1.40 m	0.40 - 0.54 m	15031	0.4 kg	15030	5.8 kg	15053	6.2 kg
	1.40 - 1.60 m	0.56 - 0.84 m	13453	0.4 kg	13452	6.7 kg	12540	7.1 kg
	1.60 - 2.05 m	0.76 - 1.22 m	13480	0.6 kg	13479	7.8 kg	13478	8.3 kg
	2.00 - 2.90 m	1.20 - 2.09 m	15011	0.8 kg	15012	10.5 kg	15013	11.3 kg
Gate valve DN500/600 SQ36	1.25 - 1.40 m	0.36 - 0.50 m	15033	0.4 kg	15032	6.7 kg	14034	7.1 kg
	1.45 - 1.65 m	0.53 - 0.76 m	14031	0.4 kg	14033	7.2 kg	14035	7.6 kg
	1.65 - 2.10 m	0.75 - 1.16 m	15035	0.6 kg	15034	8.2 kg	15056	9.3 kg
	2.10 - 2.70 m	1.13 - 1.86 m	15037	0.7 kg	15036	11.2 kg	15016	11.9 kg

*Cover depth measurements depend on the height of the valve used, see p. 11.

**Other lengths available upon request.

SPINDLE EXTENSIONS FOR GATE VALVES

Rigid Spindle Extension - Square bar -

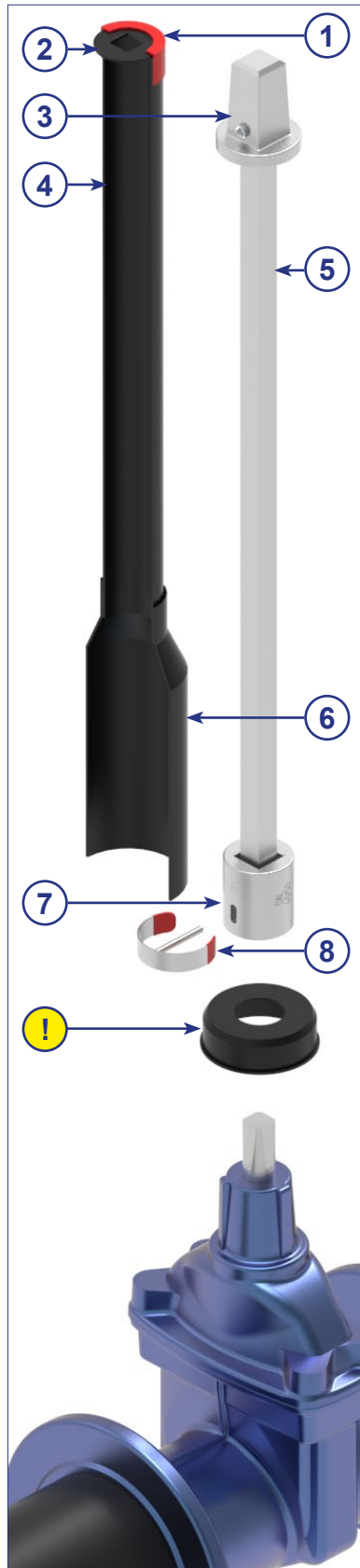

Covering cap



Centring disc



Square cap SQ27/32



Tube

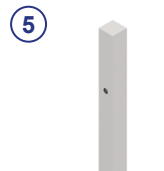

Square steel



Round bell



Coupling



Clip-pin



Bell adapter (optional)

scan me!



SPINDLE EXTENSIONS FOR GATE VALVES

Rigid Spindle Extension - Square bar -



Valve Spindle square	CD* Cover depth	Total length (L)** Spindle extension	Protection tube		Spindle extension		Complete	
			Article No.	Weight	Article No.	Weight	Article No.	Weight
Gate valve DN40/50 SQ14	0.75 m	0.45 m	13991.04	0.2 kg	13992.04	2.2 kg	13993.04	2.4 kg
	1.00 m	0.70 m	12008.04	0.2 kg	12003.04	2.9 kg	12000.04	3.1 kg
	1.25 m	0.95 m	12007.04	0.3 kg	12004.04	3.5 kg	12001.04	3.8 kg
	1.50 m	1.20 m	12006.04	0.4 kg	12005.04	4.1 kg	12002.04	4.5 kg
	2.00 m	1.70 m	13402.04	0.5 kg	13401.04	5.4 kg	13997.04	5.9 kg
Gate valve DN65/80 SQ17	0.75 m	0.41 m	15058.04	0.2 kg	13990.04	2.1 kg	13994.04	2.3 kg
	1.00 m	0.66 m	12012.04	0.2 kg	12015.04	2.7 kg	12009.04	3.0 kg
	1.25 m	0.91 m	12013.04	0.3 kg	12016.04	3.4 kg	12010.04	3.7 kg
	1.50 m	1.16 m	12014.04	0.4 kg	12017.04	4.0 kg	12011.04	4.4 kg
	2.00 m	1.66 m	13404.04	0.5 kg	13403.04	5.3 kg	13996.04	5.8 kg
Gate valve DN100-150 SQ19	0.75 m	0.31 m	15060.04	0.1 kg	15059.04	1.8 kg	14113.04	2.0 kg
	1.00 m	0.56 m	12024.04	0.2 kg	12021.04	2.5 kg	12018.04	2.7 kg
	1.25 m	0.81 m	12025.04	0.3 kg	12022.04	3.1 kg	12019.04	3.4 kg
	1.50 m	1.06 m	12026.04	0.3 kg	12023.04	3.7 kg	12020.04	4.1 kg
	2.00 m	1.56 m	13406.04	0.5 kg	13405.04	5.0 kg	12107.04	5.4 kg
Gate valve DN175/200 SQ24	0.75 m	0.24 m	15061.04	0.2 kg	15062.04	2.2 kg	13995.04	2.4 kg
	1.00 m	0.49 m	12033.04	0.2 kg	12030.04	3.5 kg	12027.04	3.7 kg
	1.25 m	0.74 m	12034.04	0.3 kg	12031.04	4.7 kg	12028.04	5.0 kg
	1.50 m	0.99 m	12035.04	0.4 kg	12032.04	5.9 kg	12029.04	6.3 kg
	2.00 m	1.49 m	13408.04	0.5 kg	13407.04	8.4 kg	15050.04	8.9 kg
Gate valve DN 250/350 SQ27	1.00 m	0.38 m	12042.04	0.2 kg	12039.04	3.1 kg	12036.04	3.3 kg
	1.25 m	0.63 m	12043.04	0.3 kg	12040.04	4.4 kg	12037.04	4.6 kg
	1.50 m	0.88 m	12044.04	0.3 kg	12041.04	5.6 kg	12038.04	5.9 kg
	2.00 m	1.38 m	13410.04	0.5 kg	13409.04	8.1 kg	15051.04	8.5 kg
Gate valve DN400/450 SQ32	1.25 m	0.45 m	12049.04	0.5 kg	12047.04	6.4 kg	12045.04	6.7 kg
	1.50 m	0.70 m	12050.04	0.4 kg	12048.04	8.2 kg	12046.04	8.6 kg
	2.00 m	1.20 m	15057.04	0.5 kg	15056.04	11.7 kg	15052.04	12.2 kg
Gate valve DN500/600 SQ36	1.00 m	-	-	-	-	-	-	-
	1.25 m	-	-	-	-	-	-	-
	1.50 m	0.60 m	14028.04	0.4 kg	14026.04	9.9 kg	14025.04	10.3 kg
	2.00 m	1.10 m	14029.04	0.5 kg	14027.04	15.2 kg	14024.04	15.7 kg
Gate valve DN500/600 SQ36 Square cap 48/54	1.00 m	-	-	-	-	-	-	-
	1.25 m	-	-	-	-	-	-	-
	1.50 m	0.60 m	14028.04D	0.4 kg	14026.04D	12.9 kg	14025.04D	13.8 kg
	2.00 m	1.10 m	14029.04D	0.5 kg	14027.04D	18.2 kg	14024.04D	18.7 kg

*Cover depth measurements depend on the height of the valve used, see p. 11.

**Other lengths available upon request.

SPINDLE EXTENSIONS FOR GATE VALVES

Rigid Spindle Extension - Round bar -

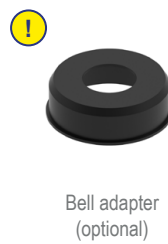
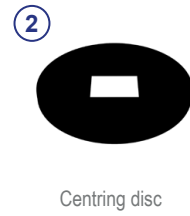
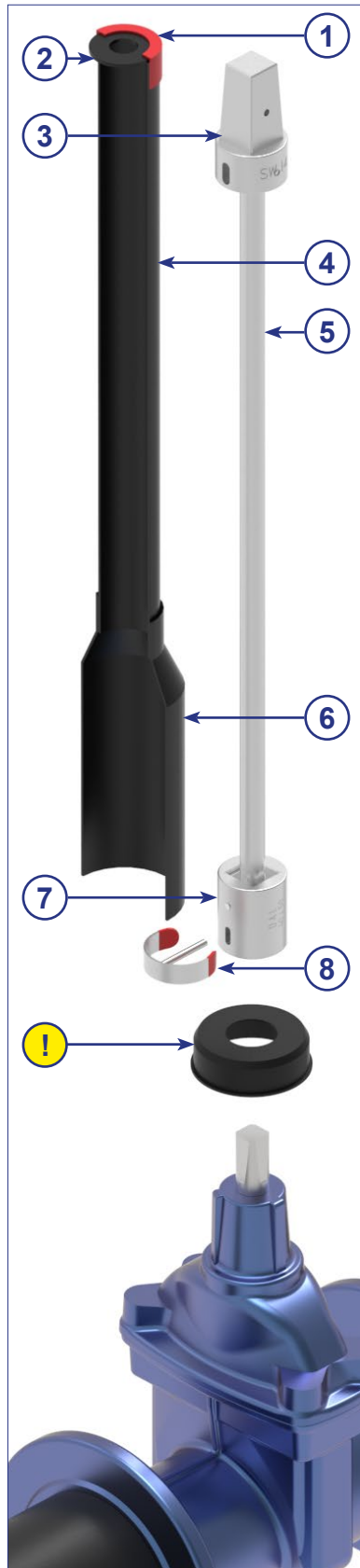

SPINDLE EXTENSIONS FOR GATE VALVES

Rigid Spindle Extension - Round bar -



Valve Spindle square	CD* Cover depth	Total length (L)** Spindle extension	Protection tube		Spindle extension		Complete	
			Article No.	Weight	Article No.	Weight	Article No.	Weight
Gate valve DN40/50 SQ14	1.00 m	0.70 m	12008	0.2 kg	12003	2.8 kg	12000	3.0 kg
	1.25 m	0.95 m	12007	0.3 kg	12004	3.2 kg	12001	3.5 kg
	1.50 m	1.20 m	12006	0.4 kg	12005	3.7 kg	12002	4.1 kg
Gate valve DN65/80 SQ17	1.00 m	0.66 m	12012	0.2 kg	12015	3.0 kg	12009	3.3 kg
	1.25 m	0.91 m	12013	0.3 kg	12016	3.8 kg	12010	4.1 kg
	1.50 m	1.16 m	12014	0.4 kg	12017	4.5 kg	12011	4.9 kg
Gate valve DN100-150 SQ19	1.00 m	0.56 m	12024	0.2 kg	12021	2.7 kg	12018	2.9 kg
	1.25 m	0.81 m	12025	0.3 kg	12022	3.5 kg	12019	3.7 kg
	1.50 m	1.06 m	12026	0.3 kg	12023	4.2 kg	12020	4.5 kg
Gate valve DN175/200 SQ24	1.00 m	0.49 m	12033	0.3 kg	12030	4.4 kg	12027	4.7 kg
	1.25 m	0.74 m	12034	0.3 kg	12031	5.8 kg	12028	6.1 kg
	1.50 m	0.99 m	12035	0.3 kg	12032	7.2 kg	12029	7.6 kg
Gate valve DN 250/350 SQ27	1.00 m	0.38 m	12042	0.2 kg	12039	4.3 kg	12036	4.4 kg
	1.25 m	0.63 m	12043	0.3 kg	12040	6.2 kg	12037	6.4 kg
	1.50 m	0.88 m	12044	0.3 kg	12041	7.6 kg	12038	7.9 kg
Gate valve DN400/450 SQ32	1.00 m	-	-	-	-	-	-	-
	1.25 m	0.45 m	12049	0.3 kg	12047	7.4 kg	12045	7.7 kg
	1.50 m	0.70 m	12050	0.4 kg	12048	9.2 kg	12046	9.8 kg

*Cover depth measurements depend on the height of the valve used, see p. 11.

**Other lengths available upon request.

SPIND

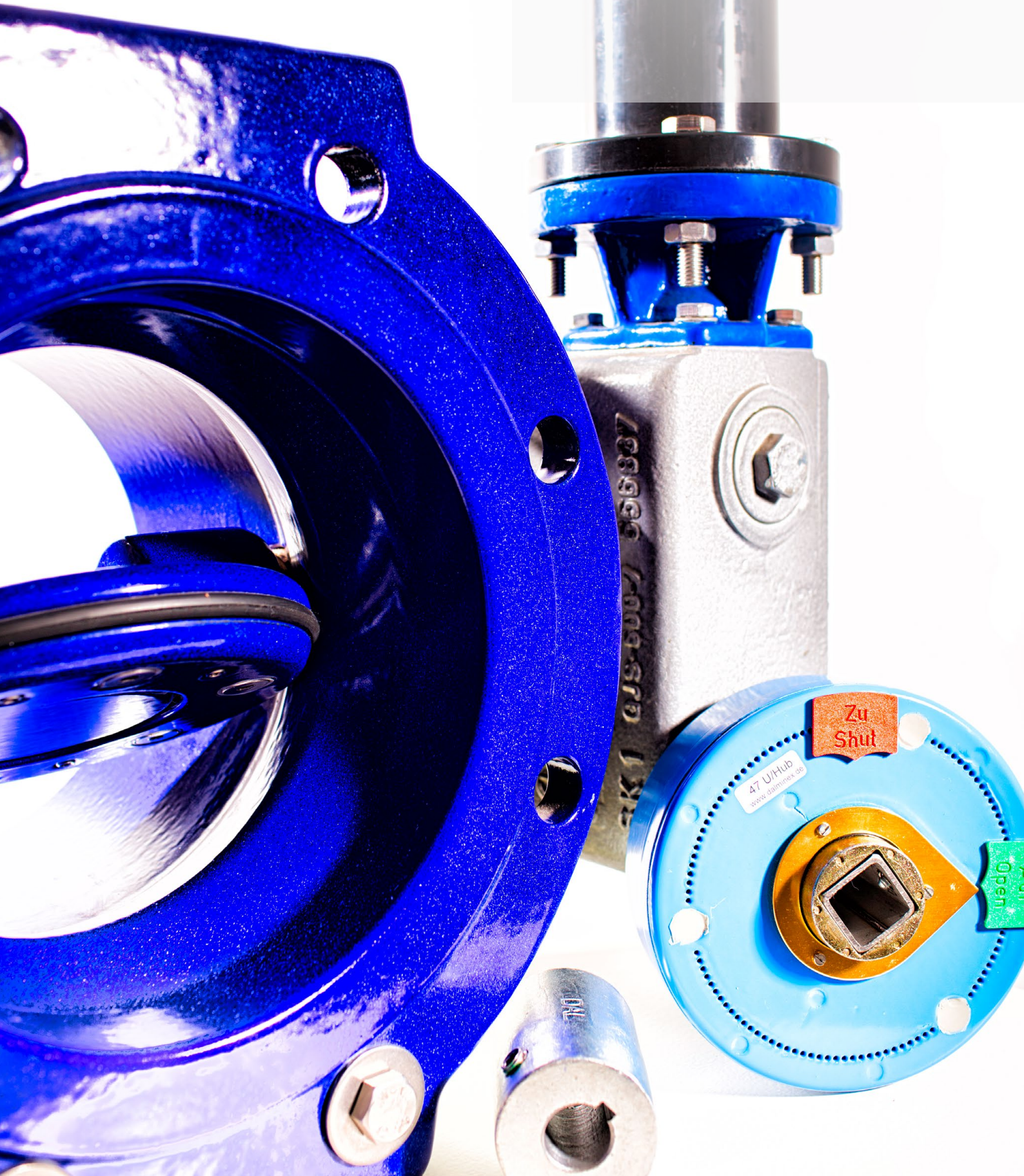

SPINDLE EXTENSIONS FOR BUTTERFLY VALVES

TABLE OF CONTENTS



Telescopic spindle extension T3 with flange bell	52 - 53
Telescopic spindle extension T3 with round bell	54 - 55

Telescopic Spindle Extension T3 with flange bell

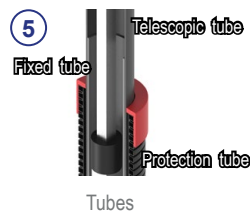
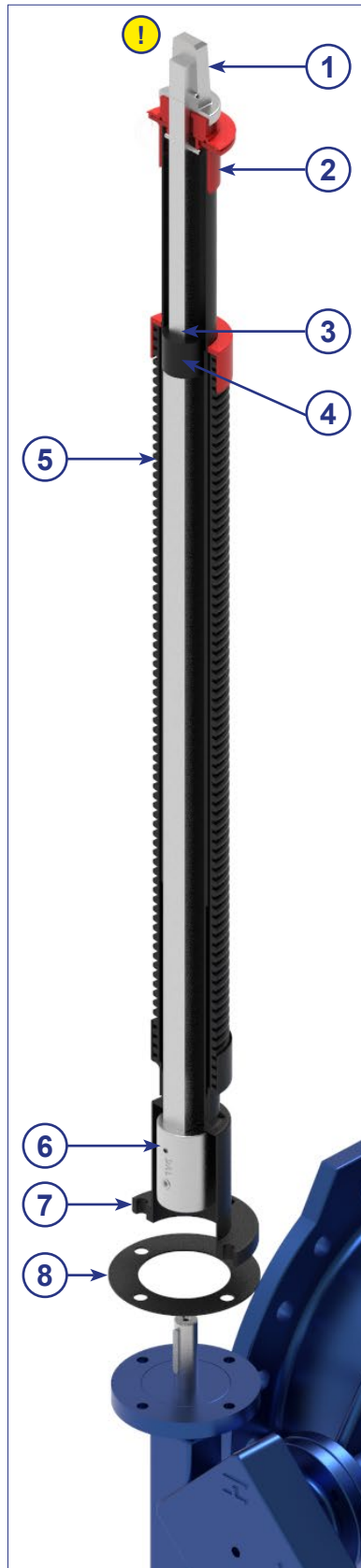

Telescopic Spindle Extension T3 with flange bell

Valve Keyway	Cover depth CD / L*	without position indicator		prepared for position indicator**		
		Article No.	Weight	Article No.	Weight	
Ø16 mm	1.00 - 1.50 m	71100.16	6.2 kg	71100.16.Z	Spindle Extension + required position indicator	
	1.20 - 1.80 m	71101.16	7.0 kg	71101.16.Z		
	1.70 - 2.70 m	71102.16	8.7 kg	71102.16.Z		
	2.50 - 3.20 m	71103.16	10.8 kg	71103.16.Z		
Ø18 mm	1.00 - 1.50 m	71100.18	5.8 kg	71100.18.Z	Spindle Extension + required position indicator	
	1.20 - 1.80 m	71101.18	6.6 kg	71101.18.Z		
	1.70 - 2.70 m	71102.18	8.2 kg	71102.18.Z		
	2.50 - 3.20 m	71103.18	10.3 kg	71103.18.Z		
Ø20 mm	1.00 - 1.50 m	71100.20	5.7 kg	71100.20.Z	Spindle Extension + required position indicator	
	1.20 - 1.80 m	71101.20	6.6 kg	71101.20.Z		
	1.70 - 2.70 m	71102.20	8.6 kg	71102.20.Z		
	2.50 - 3.20 m	71103.20	10.3 kg	71103.20.Z		
Ø22 mm	1.00 - 1.50 m	72100.22	5.7 kg	72100.22.Z	Spindle Extension + required position indicator	
	1.20 - 1.80 m	72101.22	6.5 kg	72101.22.Z		
	1.70 - 2.70 m	72102.22	8.2 kg	72102.22.Z		
	2.50 - 3.20 m	72103.22	10.3 kg	72103.22.Z		
Ø30 mm	1.00 - 1.50 m	73100.30	6.2 kg	73100.30.Z	Spindle Extension + required position indicator	
	1.20 - 1.80 m	73101.30	7.0 kg	73101.30.Z		
	1.70 - 2.70 m	73102.30	8.6 kg	73102.30.Z		
	2.50 - 3.20 m	73103.30	10.7 kg	73103.30.Z		

*Other lengths available upon request.

**Please note that the spindle extensions are prepared for a position indicator. The required position indicator can be found on p. 68.

Protective cover

Description	Article No.	Weight
Protective cover for mechanical position indicator with operating cap	11648	0.17 kg



Adapter disk

Description	Article No.	Weight
Adapter disk F14 for F10 bell	12770.10	0.08 kg



SPINDLE EXTENSIONS FOR BUTTERFLY VALVES

Telescopic Spindle Extension T3 with round bell

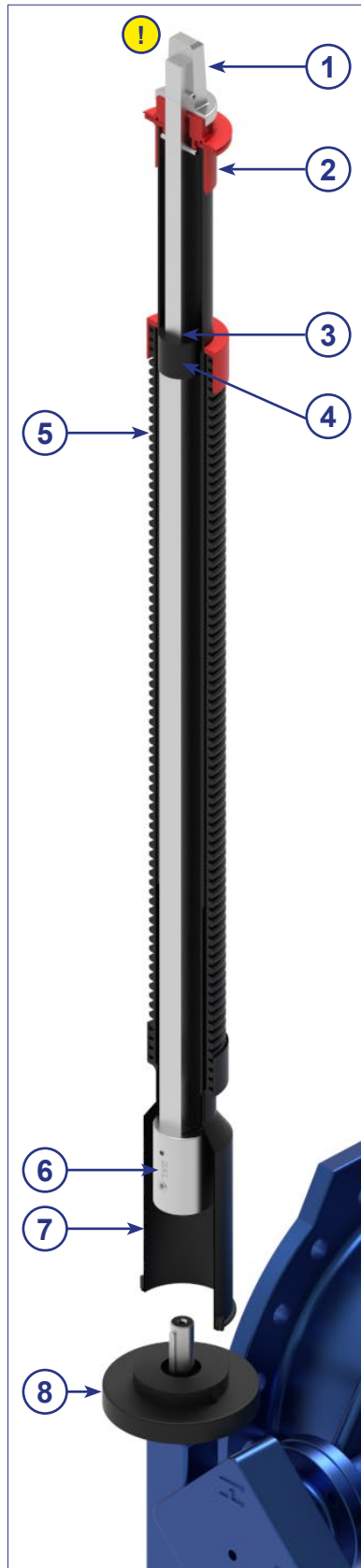

①



Square cap

②



Centring cap

③



PE-brake

④



Transport lock

⑤



Tubes

⑥



Coupling with screw

⑦



Round bell

⑧

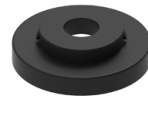

Bell adapter

⑨



Clip-pin

!



Optional:
Mechanical
position indicator
made of stainless steel

scan me!



SPINDLE EXTENSIONS FOR BUTTERFLY VALVES

Telescopic Spindle Extension T3 with round bell

Valve Keyway	Cover depth CD / L*	without position indicator		prepared for position indicator**	
		Article No.	Weight	Article No.	Weight
Ø16 mm	1.00 - 1.50 m	71000.16	4.5 kg	71000.16.Z	Spindle Extension + required position indicator
	1.20 - 1.80 m	71001.16	6.8 kg	71001.16.Z	
	1.70 - 2.70 m	71002.16	8.5 kg	71002.16.Z	
	2.50 - 3.20 m	71003.16	10.6 kg	71003.16.Z	
Ø18 mm	1.00 - 1.50 m	71000.18	5.7 kg	71000.18.Z	Spindle Extension + required position indicator
	1.20 - 1.80 m	71001.18	6.4 kg	71001.18.Z	
	1.70 - 2.70 m	71002.18	8.1 kg	71002.18.Z	
	2.50 - 3.20 m	71003.18	10.2 kg	71003.18.Z	
Ø20 mm	1.00 - 1.50 m	71000.20	5.6 kg	71000.20.Z	Spindle Extension + required position indicator
	1.20 - 1.80 m	71001.20	6.4 kg	71001.20.Z	
	1.70 - 2.70 m	71002.20	8.0 kg	71002.20.Z	
	2.50 - 3.20 m	71003.20	10.2 kg	71003.20.Z	
Ø22 mm	1.00 - 1.50 m	72000.22	5.7 kg	72000.22.Z	Spindle Extension + required position indicator
	1.20 - 1.80 m	72001.22	6.4 kg	72001.22.Z	
	1.70 - 2.70 m	72002.22	8.1 kg	72002.22.Z	
	2.50 - 3.20 m	72003.22	10.1 kg	72003.22.Z	
Ø30 mm	1.00 - 1.50 m	73000.30	6.0 kg	73000.30.Z	Spindle Extension + required position indicator
	1.20 - 1.80 m	73001.30	6.8 kg	73001.30.Z	
	1.70 - 2.70 m	73002.30	8.5 kg	73002.30.Z	
	2.50 - 3.20 m	73003.30	10.6 kg	73003.30.Z	

*Other lengths available upon request.

**Please note that that the spindle extensions are prepared for a position indicator. The required position indicator can be found on p. 68.

Protective cover

Description	Article No.	Weight
Protective cover for mechanical position indicator with operating cap	11648	0.17 kg



SPIND



SPINDLE EXTENSIONS FOR BALL VALVES

TABLE OF CONTENTS

Telescopic spindle extension T3 with square connection	58 - 59
Telescopic spindle extension T3 with polygon	60 - 61

Telescopic Spindle Extension T3 with square connection



①



Square cap with screw

②



Position indicator

③

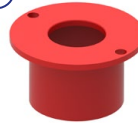

Centring cap

④



Transport lock

⑤



PE-brake

⑥



Tubes

⑦



Round bell

⑧



Split pin

⑨



Clip-pin polygon

scan me!



Telescopic Spindle Extension T3 with square connection



Suitable for FRIALEN KH					
d	CD* Cover depth	Article No. without position indicator	Article No. with position indicator, yellow	Article No. with position indicator, blue	Weight
32-50 SQ20 with Split pin	0.45 - 0.70 m	FRI14004	FRI14004.14G	FRI14004.14B	1.4 kg
	0.60 - 1.00 m	FRI14005	FRI14005.14G	FRI14005.14B	1.9 kg
	1.00 - 1.50 m	FRI14006	FRI14006.14G	FRI14006.14B	2.7 kg
	1.20 - 2.00 m	FRI14007	FRI14007.14G	FRI14007.14B	3.2 kg
63-225 SQ25 with Split pin	0.60 - 1.00 m	FRI14014	FRI14014.18G	FRI14014.18B	3.0 kg
	1.00 - 1.50 m	FRI14015	FRI14015.18G	FRI14015.18B	4.2 kg
	1.20 - 2.00 m	FRI14016	FRI14016.18G	FRI14016.18B	5.2 kg

Suitable for RMA KH					
d	CD* Cover depth	Article No. without position indicator	Article No. with position indicator, yellow	Article No. with position indicator, blue	Weight
32-63 SQ20 with Spring pin	0.45 - 0.70 m	RMA14004	RMA14004.14G	RMA14004.14B	1.5 kg
	0.60 - 1.00 m	RMA14005	RMA14005.14G	RMA14005.14B	1.9 kg
	1.00 - 1.50 m	RMA14006	RMA14006.14G	RMA14006.14B	2.8 kg
	1.20 - 2.00 m	RMA14007	RMA14007.14G	RMA14007.14B	3.4 kg
90-180 SQ25 with Spring pin	0.60 - 1.00 m	RMA14008	RMA14008.18G	RMA14008.18B	3.1 kg
	1.00 - 1.50 m	RMA14009	RMA14009.18G	RMA14009.18B	4.4 kg
	1.20 - 2.00 m	RMA14010	RMA14010.18G	RMA14010.18B	4.7 kg

Suitable for AGRU/FRANK (bell suitable for AGRU Adapter)					
d	CD* Cover depth	Article No. without position indicator	Article No. with position indicator, yellow	Article No. with position indicator, blue	Weight
32-63 SQ20 with Split pin	0.60 - 0.80 m	10088.GWC	10088.GWC.14G	10088.GWC.14B	1.6 kg
	0.80 - 1.20 m	14004.GWC	14004.GWC.14G	14004.GWC.14B	1.8 kg
	1.00 - 1.50 m	14005.GWC	14005.GWC.14G	14005.GWC.14B	2.3 kg
	1.20 - 1.80 m	14006.GWC	14006.GWC.14G	14006.GWC.14B	2.9 kg
	1.50 - 2.20 m	14007.GWC	14007.GWC.14G	14007.GWC.14B	3.2 kg
90-225 SQ25 with Split pin	0.60 - 0.80 m	14008.GWC	14008.GWC.18G	14008.GWC.18B	2.6 kg
	0.80 - 1.20 m	13999.GWC	13999.GWC.18G	13999.GWC.18B	3.5 kg
	1.00 - 1.50 m	14014.GWC	14014.GWC.18G	14014.GWC.18B	4.0 kg
	1.20 - 1.80 m	14015.GWC	14015.GWC.18G	14015.GWC.18B	4.9 kg
	1.50 - 2.20 m	14016.GWC	14016.GWC.18G	14016.GWC.18B	4.8 kg

Suitable for AVK Magnus (Connection as per GW336)					
d	CD* Cover depth	Article No. without position indicator	Article No. with position indicator, yellow	Article No. with position indicator, blue	Weight
25-63 SQ20 without Split pin	0.80 - 1.20 m	AVK14005	AVK14005.14G	AVK14005.14B	1.7 kg
	1.10 - 1.60 m	AVK14006	AVK14006.14G	AVK14006.14B	2.4 kg
	1.30 - 2.20 m	AVK14007	AVK14007.14G	AVK14007.14B	3.4 kg
90-180 SQ25 without Split pin	0.80 - 1.20 m	AVK13999	AVK13999.18G	AVK13999.18B	3.4 kg
	1.10 - 1.60 m	AVK14015	AVK14015.18G	AVK14015.18B	4.0 kg
	1.30 - 2.20 m	AVK14016	AVK14016.18G	AVK14016.18B	5.3 kg

Connection pins			
Description	Size	Article No.	Weight
Clip-pin polygon	Ø4x62 mm / A2	100326	0.01 kg
Split pin	Ø4x63 mm / A2	100309	0.01 kg
Spring pin	Ø2,5x75 mm	100301	0.01 kg

*Cover depth measurements depend on the height of the valve used, see p. 11.
Other lengths available upon request.

Subject to technical modifications!

Telescopic Spindle Extension T3 with Polygon



①



Square cap

②



Position indicator

③

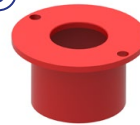

Centring cap

④



Transport lock

⑤



PE-brake

⑥

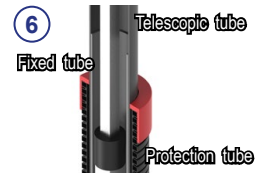

Tubes

⑦



Polygon steel coupling

⑧



Round bell

scan me!



SPINDLE EXTENSIONS FOR BALL VALVES

Telescopic Spindle Extension T3 with Polygon



Suitable for FRIALEN					
d	CD* Cover depth	Article No. <small>without position indicator</small>	Article No. <small>with position indicator, yellow</small>	Article No. <small>with position indicator, blue</small>	Weight
32-50 Polygon	0.45 - 0.70 m	FRI14004.00	FRI14004.00.14G	FRI14004.00.14B	2.1 kg
	0.60 - 1.00 m	FRI14005.00	FRI14005.00.14G	FRI14005.00.14B	2.4 kg
	1.00 - 1.50 m	FRI14006.00	FRI14006.00.14G	FRI14006.00.14B	3.7 kg
	1.20 - 2.00 m	FRI14007.00	FRI14007.00.14G	FRI14007.00.14B	3.7 kg
63-225 Polygon	0.60 - 1.00 m	FRI14014.00	FRI14014.00.18G	FRI14014.00.18B	3.0 kg
	1.00 - 1.50 m	FRI14015.00	FRI14015.00.18G	FRI14015.00.18B	4.5 kg
	1.20 - 2.00 m	FRI14016.00	FRI14016.00.18G	FRI14016.00.18B	5.1 kg
Suitable for RMA					
d	CD* Cover depth	Article No. <small>without position indicator</small>	Article No. <small>with position indicator, yellow</small>	Article No. <small>with position indicator, blue</small>	Weight
32-63 Polygon	0.45 - 0.70 m	RMA14004.00	RMA14004.00.14G	RMA14004.00.14B	1.6 kg
	0.60 - 1.00 m	RMA14005.00	RMA14005.00.14G	RMA14005.00.14B	2.0 kg
	1.00 - 1.50 m	RMA14006.00	RMA14006.00.14G	RMA14006.00.14B	2.8 kg
	1.20 - 2.00 m	RMA14007.00	RMA14007.00.14G	RMA14007.00.14B	3.5 kg
90-180 Polygon	0.60 - 1.00 m	RMA14008.00	RMA14008.00.18G	RMA14008.00.18B	3.1 kg
	1.00 - 1.50 m	RMA14009.00	RMA14009.00.18G	RMA14009.00.18B	4.6 kg
	1.20 - 2.00 m	RMA14010.00	RMA14010.00.18G	RMA14010.00.18B	4.7 kg
Suitable for AGRU/FRANK (bell suitable for AGRU Adapter)					
d	CD* Cover depth	Article No. <small>without position indicator</small>	Article No. <small>with position indicator, yellow</small>	Article No. <small>with position indicator, blue</small>	Weight
32-63 Square	0.60 - 0.80 m	10088.GWC.00	10088.GWC.00.14G	10088.GWC.00.14B	1.9 kg
	0.80 - 1.20 m	14004.GWC.00	14004.GWC.00.14G	14004.GWC.00.14B	3.2 kg
	1.00 - 1.50 m	14005.GWC.00	14005.GWC.00.14G	14005.GWC.00.14B	2.5 kg
	1.20 - 1.80 m	14006.GWC.00	14006.GWC.00.14G	14006.GWC.00.14B	3.0 kg
	1.50 - 2.20 m	14007.GWC.00	14007.GWC.00.14G	14007.GWC.00.14B	3.2 kg
90-225 Square	0.60 - 0.80 m	14008.GWC.00	14008.GWC.00.18G	14008.GWC.00.18B	2.7 kg
	0.80 - 1.20 m	13999.GWC.00	13999.GWC.00.18G	13999.GWC.00.18B	3.7 kg
	1.00 - 1.50 m	14014.GWC.00	14014.GWC.00.18G	14014.GWC.00.18B	3.8 kg
	1.20 - 1.80 m	14015.GWC.00	14015.GWC.00.18G	14015.GWC.00.18B	4.5 kg
	1.50 - 2.20 m	14016.GWC.00	14016.GWC.00.18G	14016.GWC.00.18B	4.9 kg
Suitable for AVK Magnus (Bell connection as per GW336)					
d	CD* Cover depth	Article No. <small>without position indicator</small>	Article No. <small>with position indicator, yellow</small>	Article No. <small>with position indicator, blue</small>	Weight
63-180 Polygon	0.80 - 1.20 m	AVK13999.00	AVK13999.00.18G	AVK13999.00.18B	4.0 kg
	1.10 - 1.60 m	AVK14015.00	AVK14015.00.18G	AVK14015.00.18B	4.6 kg
	1.30 - 2.20 m	AVK14016.00	AVK14016.00.18G	AVK14016.00.18B	5.3 kg

*Cover depth measurements depend on the height of the valve used, see p. 11.
Other lengths available upon request.

SPIND



OLE EXTENSIONS SPECIAL APPLICATIONS

TABLE OF CONTENTS



Telescopic Spindle Extension T3 for Service valves with screw bell	64 - 65
Telescopic Spindle Extension T3 for Gate valves with screw bell	66 - 67

Telescopic Spindle Extension T3 for Service valves with screw bell

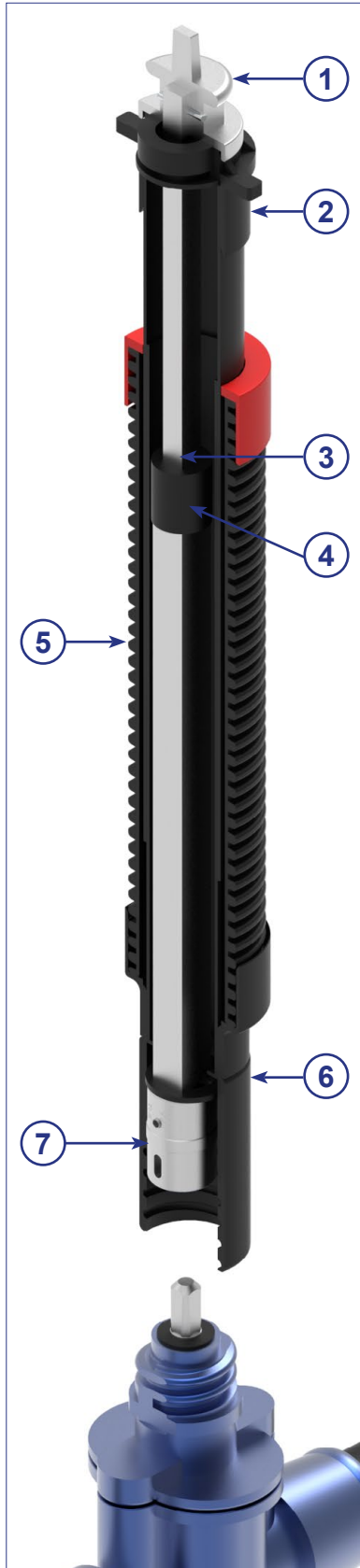

Square cap



Centring cap



Transport lock

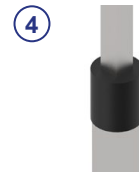

PE-brake



Tubes



PE-Screw bell



Coupling

scan me!



Telescopic Spindle Extension T3 for Service valves with screw bell



Valve Spindle square	CD* Cover depth	Article No.	Weight
Service valve SQ12	0.75 - 1.10 m	14072.HAW	2.3 kg
	1.00 - 1.50 m	14073.HAW	3.1 kg
	1.30 - 2.00 m	14074.HAW	3.8 kg
	1.50 - 2.50 m	14075.HAW	4.5 kg

*Other lengths available upon request.

PE-screw bell with suitable connection to valve.
The screw connection is without connecting pin.

Special application



Mount the screw bell onto the gate valve and the coupling will be connected to the spindle. The screw connection is without connecting pin.

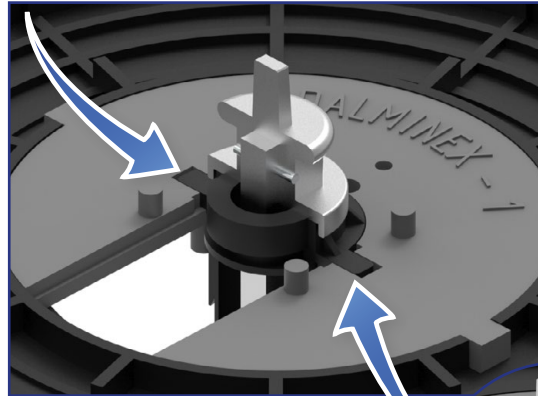

Our wing cap fits perfectly into the DALMINEX installation system. (see p. 87).

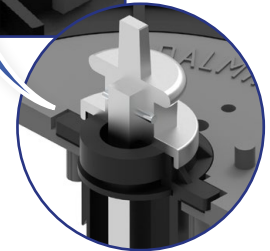

Telescopic Spindle Extension T3 for Gate valves with screw bell

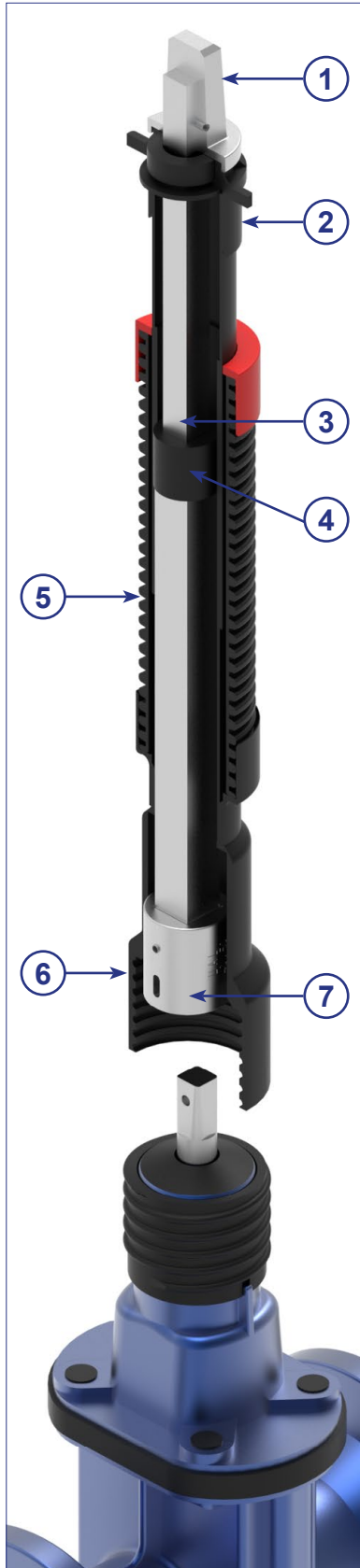

①



Square cap

②



Centring cap

③



Transport lock

④



PE-brake

⑤



Tubes

⑥



PE-Screw bell

⑦



Coupling

scan me!



Telescopic Spindle Extension T3 for Gate valves with screw bell



Valve Spindle square	CD* Cover depth	Article No.	Weight
Gate valve DN40/50 SQ14	0.75 - 1.00 m	14076	3.2 kg
	1.00 - 1.45 m	14077	4.4 kg
	1.30 - 2.05 m	14078	5.9 kg
	1.70 - 2.50 m	20325	7.9 kg
Gate valve DN65/80 SQ17	0.75 - 1.00 m	14079	3.3 kg
	1.00 - 1.40 m	14080	4.4 kg
	1.30 - 2.00 m	14081	5.6 kg
	1.70 - 2.50 m	20326	7.5 kg
Gate valve DN100-150 SQ19	0.75 - 1.00 m	14082	2.9 kg
	1.00 - 1.30 m	14083	4.1 kg
	1.30 - 1.90 m	14084	5.4 kg
	1.70 - 2.50 m	20327	7.4 kg
Gate valve DN200 SQ24	1.10 - 1.35 m	14085	4.5 kg
	1.30 - 1.85 m	14086	6.0 kg
	1.70 - 2.50 m	14112	9.5 kg
Gate valve DN250/300 SQ27 with Round bell	1.20 - 1.50 m	14087	5.0 kg
	1.50 - 1.80 m	14088	6.8 kg
	2.00 - 2.50 m	20328	9.3 kg

*Other lengths available upon request.

PE-screw bell with suitable connection to valve.
The screw connection is without connecting pin.

Special application



Mount the screw bell onto the gate valve and the coupling will be connected to the spindle. The screw connection is without connecting pin.



Our wing cap fits perfectly into the DAlMINEX installation system. (see p. 87).

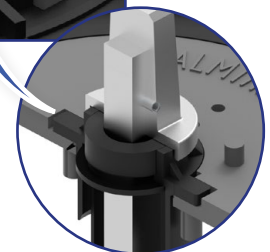

POSITION MAP

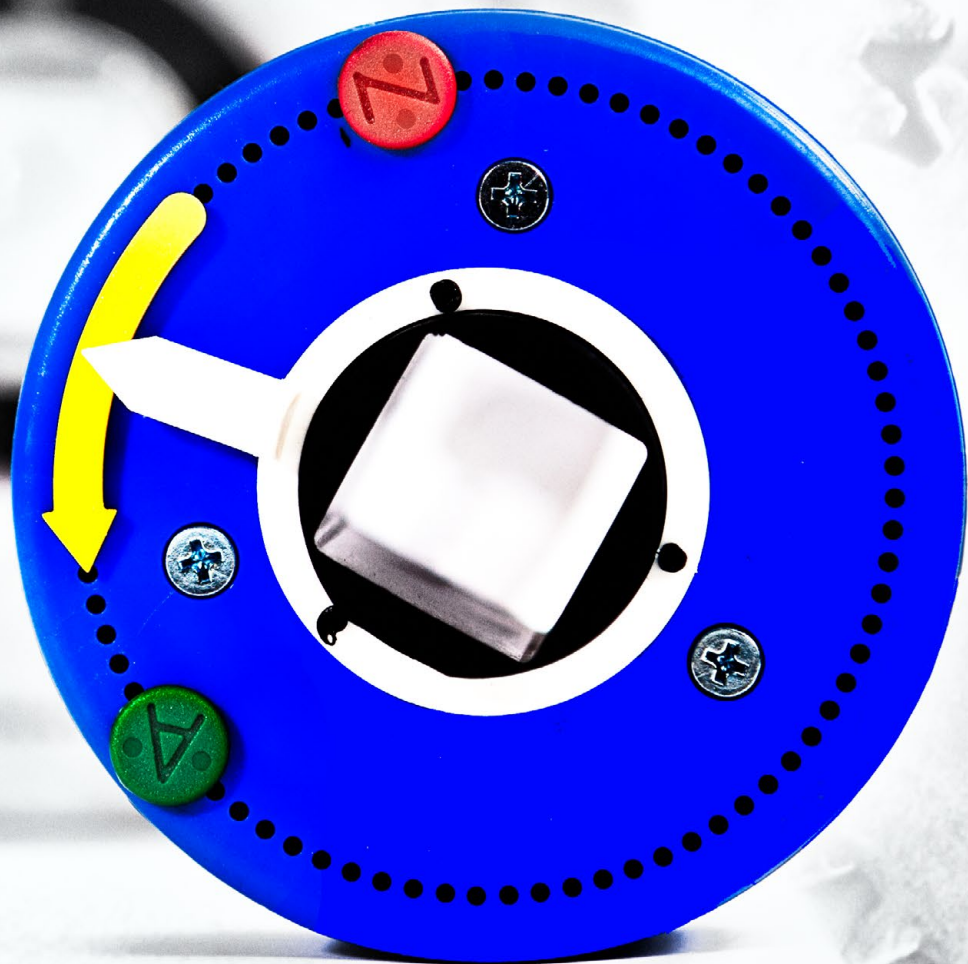

DALMINEX GmbH

POSITION INDICATORS & MARKING SYSTEMS

TABLE OF CONTENTS

Mechanical position indicator	70 - 71
Mechanical position indicator, stainless steel	72 - 73
Electrical position indicator, stainless steel	74 - 77
Position indicator, plastic	78
Marking discs & Cover caps	79

POSITION INDICATORS

Mechanical position indicator, plastic

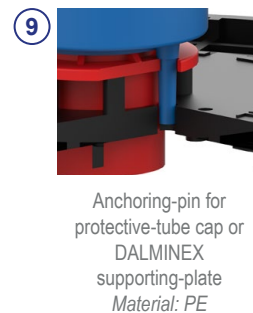
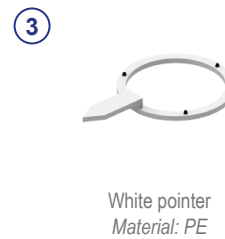
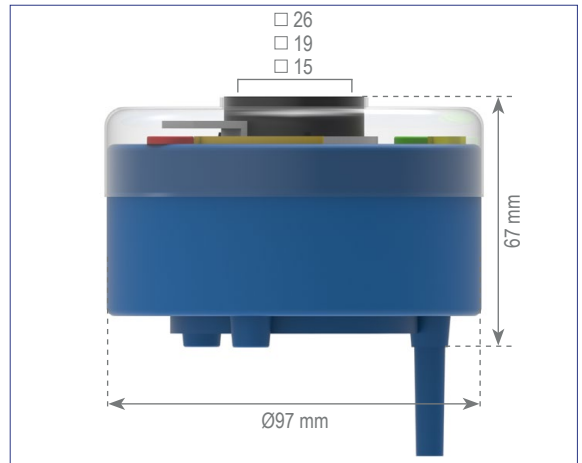
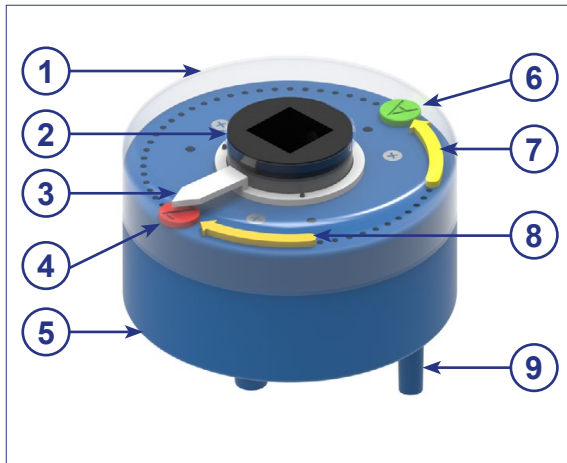

Mechanical position indicator, plastic



max. turns/ stroke	Inner-Square	Spindle extension	Article No.	Weight
81	□ 15 mm	DN40/50	13930	0.2 kg
81	□ 19 mm	DN65-150	13931	0.2 kg
81	□ 26 mm	DN175-300	13932	0.2 kg

DALMINEX installation system

DALMINEX support plate (suitable for position indicators)

Material	Article No.	Weight
Plastic	12601.01	14.0 kg



DALMINEX fixing disc suitable for DALMINEX support plate

Material	Article No.	Weight
Plastic	12602.01	1.16 kg

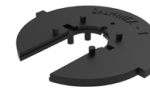

Surface box acc. to DIN 4056 Type 2

Material	Article No.	Weight
Plastic	4056-2.WK	12.1 kg



Full function and warranty through professional installation of the DALMINEX installation system.



Surface box DIN 4056 Type 2

Replaceable spare parts

Description	Article No.	Weight
Protective cover	13913.19	0.52 kg
Open/Close marking-pins, green/red	13933.01	0.01 kg
Direction arrow, yellow (anti-clockwise)	13933.02-L	0.01 kg
Direction arrow, yellow (clockwise)	13933.02-R	0.01 kg

Attention! DALMINEX position indicators cannot subsequently be installed on unprepared spindle extensions!

Subject to technical modifications!

Mechanical position indicator, stainless steel

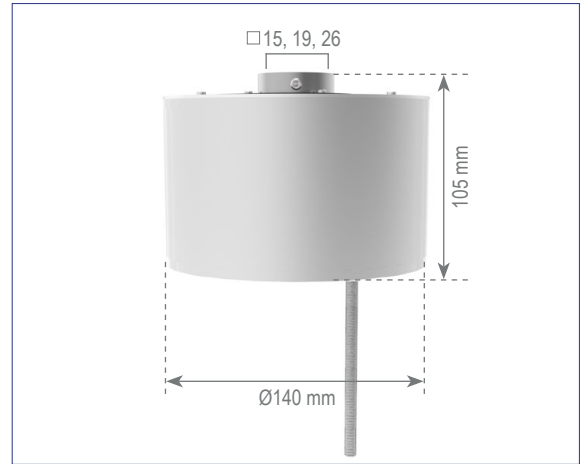
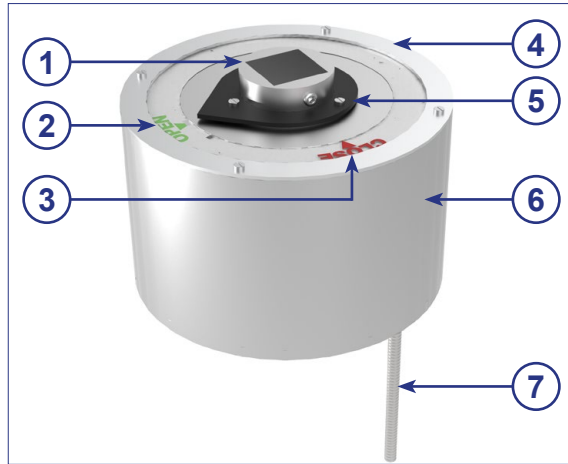

1



Adapter with centring-hole
Material: Cast zinc

2



Marking disc (OPEN)
Material: PMMA
Replaceable spare part

3



Marking disc (CLOSE), transparent
Material: PMMA
Replaceable spare part

4

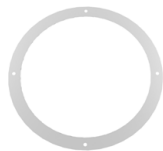

Holding disc
Material: 1.4301
Replaceable spare part

5



Pointer, black
Material: S235JR epoxy

6

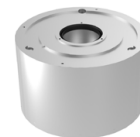

Body
Material: 1.4301

7

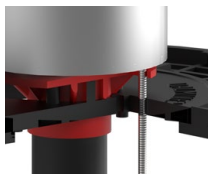

Anchoring-pin for protective-tube cap or DALMINEX supporting-plate
Material: 1.4301

scan me!



Mechanical position indicator, stainless steel

max. turns/stroke	Square insert		Weight
	□ 19 mm	□ 26 mm	
14	13019.14RZW	13026.14RZW	5.0 kg
47	13019.47RZW	13026.47RZW	5.0 kg
140	13019.140RZW	13026.140RZW	5.0 kg
470	13019.470RZW	13026.470RZW	5.0 kg

DALMINEX installation system

DALMINEX support plate (suitable for position indicators)

Material	Article No.	Weight
Plastic	12601.01	14.0 kg



DALMINEX fixing disc suitable for DALMINEX support plate

Material	Article No.	Weight
Plastic	12602.01	1.16 kg

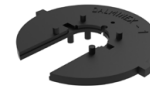

Surface box acc. to DIN 4056 Type 2

Material	Article No.	Weight
Plastic	4056-2.WK	12.1 kg



Full function and warranty through professional installation of the DALMINEX installation system.



Surface box DIN 4056 Type 2

Replaceable spare parts

Description	Article No.	Weight
Marking disc (OPEN)	O-22794	0.004 kg
Marking disc (CLOSE)	C-22794	0.004 kg
Holding disc	22794	0.01 kg

Attention! DALMINEX position indicators cannot subsequently be installed on unprepared spindle extensions!

Subject to technical modifications!

Electrical position indicator, stainless steel

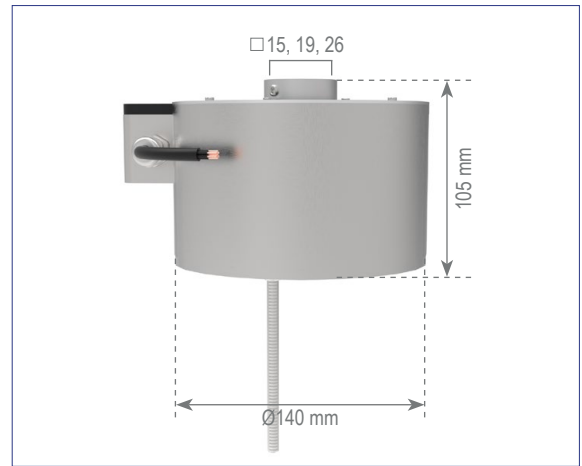
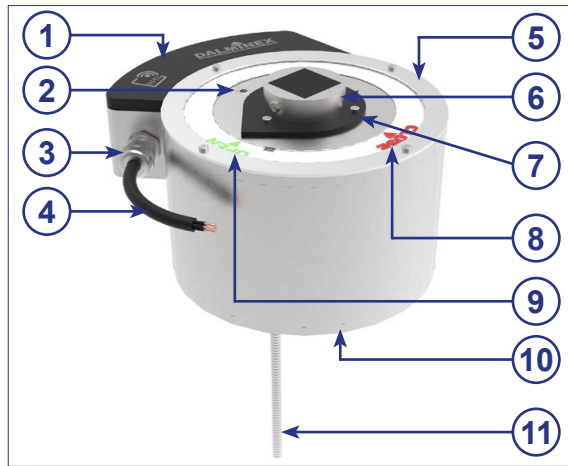

RFID disc
Material: ASA



Set screw M8x10 mm
Material: 1.4301



Strain relief
Material: Nickel-plated brass



Control cable
(waterproof)



Holding disc
Material: 1.4301
Replaceable spare part

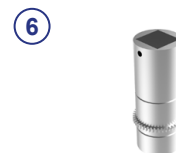

Adapter with
centring-hole
Material: Cast zinc



Pointer, black
Material: S235JR epoxy

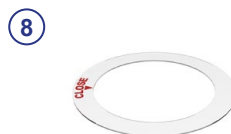

Marking disc
(CLOSE), transparent
Material: PMMA
Replaceable spare part



Marking disc
(OPEN)
Material: PMMA
Replaceable spare part



Body
Material: 1.4301

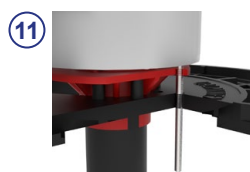

Anchoring-pin for
protective-tube cap or
DALMINEX supporting-
plate
Material: 1.4301

scan me!



Electrical position indicator, stainless steel

max. turns/stroke	Square insert		Weight
	□ 19 mm	□ 26 mm	
14	13019.14EZW	13026.14EZW	5.9 kg
47	13019.47EZW	13026.47EZW	5.9 kg
140	13019.140EZW	13026.140EZW	5.9 kg
470	13019.470EZW	13026.470EZW	5.9 kg

DALMINEX installation system

DALMINEX support plate (suitable for position indicators)

Material	Article No.	Weight
Plastic	12601.01	14.0 kg



DALMINEX fixing disc suitable for DALMINEX support plate

Material	Article No.	Weight
Plastic	12602.01	1.16 kg

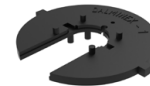

Surface box acc. to DIN 4056 Type 2

Material	Article No.	Weight
Plastic	4056-2.WK	12.1 kg



Full function and warranty through professional installation of the DALMINEX installation system.



Surface box DIN 4056 Type 2

Replaceable spare parts

Description	Article No.	Weight
Marking disc (OPEN)	O-22794	0.004 kg
Marking disc (CLOSE)	C-22794	0.004 kg
Holding disc	22794	0.01 kg

Attention! DALMINEX position indicators cannot subsequently be installed on unprepared spindle extensions!

Subject to technical modifications!



Electrical position indicator, stainless steel

With reed contact switch for line monitoring open and close.

Stainless steel body for installation on a spindle extension buried or in a chamber

- ◆ Capsuled and waterproof in accordance with IP68 DIN 40050
- ◆ Screws and connecting parts are in stainless steel
- ◆ Inner area is grease-proofed
- ◆ Electrical parts are sealed with epoxy resin
- ◆ Maintenance-free
- ◆ Working temperature between -40 bis +105 °C
- ◆ Suitable for use with surface box type DIN 4056 size 2

360° Installation intervals:

- ◆ 0 – 14 turns/stroke
- ◆ 0 – 47 turns/stroke
- ◆ 0 – 140 turns/stroke
- ◆ 0 – 470 turns/stroke

Available for use with following square rod dimensions*:

- ◆ 18x18 mm
- ◆ 25x25 mm

**other options available upon request.*

Available for use with following keyway dimensions:

- ◆ Upon request

Electrical data

Magnetic switch, one changeover contact each for opening and closing

Switch voltage: \exists 1 V bis 20 V

Switch capacity: 100 VA at a max. 500 mA

Protection class: min. IP68, DIN 40050

Connection:

Control cable (7x0,5mm²)

Length 1,5m (other lengths available upon request)

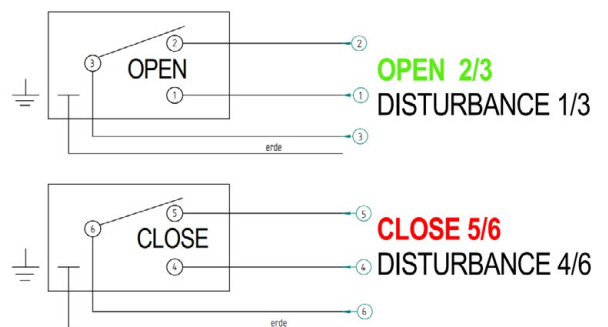

Please take note of the following:

- ◆ The connection and installation of the position indicator must always be carried out by trained personnel.
- ◆ The switch connection cable must hang freely down and shouldn't look up or be bent.
- ◆ The cable-ends have to be water-tight against moisture through cast-resin joints etc.
- ◆ The surface box must be installed such that the water entry can freely flow away.
- ◆ The cable-ends should not lie in water as this would get into the switch housing.
- ◆ The switch should not be used in an aggressive environment as this could affect the seal of the switch housing.
- ◆ The switch housing is protected by up to class IP68.

In cases where the points above have not been followed, the warranty will be void!

Warranty claims are only possible with an original DALMINEX Spindle Extension. For safe installation and reliable functionality, we recommend our DALMINEX installation system.

Installation example



Position indicator, plastic

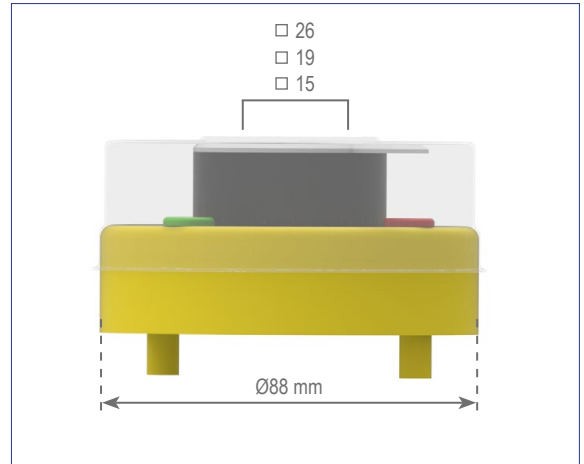
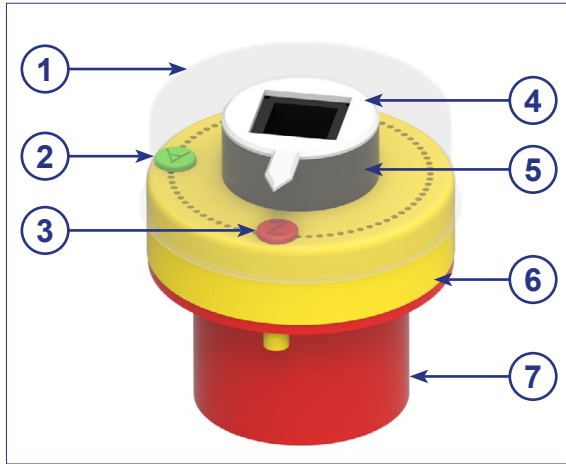

①



Protective cover,
transparent
Material: PE

②



Green marking pin „O“
(open)
Material: PA

③



Red marking pin „C“
(close)
Material: PA

④



White pointer
Material: PE

⑤

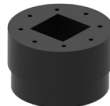

Square insert for
15 mm, 19 mm, 26 mm
Material: PE

⑥

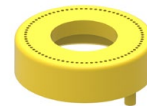

Body, yellow
(optionally available in
blue)
Material: PE

⑦



Centring cap
Material: PE

Ratio	Suitable for square insert	Article No. yellow	Article No. blue	Weight
1:1	14x14 mm	13914.14G	13914.14B	0.09 kg
1:1	18x18 mm	13914.18G	13914.18B	0.09 kg
1:1	25x25 mm	13914.25G	13914.25B	0.09 kg

Secured with either a special DALMINEX Centring cap or DALMINEX support plate, see p. 87.
Attention! DALMINEX position indicators cannot subsequently be installed on unprepared spindle extensions!

Subject to technical modifications!

scan me!



Marking discs for Telescopic Spindle Extension (Locking device)

Imprint	Color	Article No.	Weight
No Imprint	blue/yellow	2314006-11	0.01 kg

Customised labeling available with a minimum order of 100 pieces.

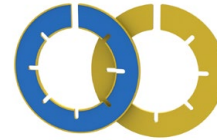

Cover caps for Spindle Extensions

Typ	Color	Imprint	Article No.	Weight
Service valve	red	do not open*	19100	0.06 kg
Gate valve	red	do not open*	19111	0.20 kg
Service valve	black	No imprint	19112	0.06 kg
Gate valve	black	No imprint	19113	0.20 kg
Service valve	blue	No imprint	19114	0.06 kg
Gate valve	blue	No imprint	19115	0.20 kg
Service valve	yellow	No imprint	19116	0.06 kg
Gate valve	yellow	No imprint	19117	0.20 kg



*German imprint: "nicht öffnen".

scan me!





OPERATING KEYS

TABLE OF CONTENTS

DIN 3223: Operating keys A	82
DIN 3223: Operating keys B	82
DIN 3223: Operating keys C, D, E	82
Operating keys similar to DIN 3223	82
Safety handwheel wrench	82
Surface box hooks	83
Handwheels	83
Screw and washer sets	83

OPERATING KEYS

DIN 3223: Operating key A for hydrants

Material	Article No.	Weight	PU
GJS400-15	12146.00	1.3 kg	10

PU = Deliveries only possible in pack units!

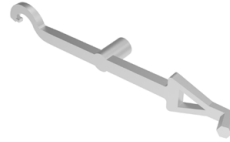

DIN 3223: Operating key B for above ground hydrants

Material	Article No.	Weight	PU
GJS400-15	13099	1.5 kg	10

PU = Deliveries only possible in pack units!



DIN 3223: Operating keys C, D, E

DIN 3223	suitable for	Length*	Width	Material	Article No.	Weight	PU
Form E	Service connection valves	750 mm (1)	320 mm	S235JR	13429	1.5 kg	-
Form E	Service connection valves	1000 mm (2)	320 mm	S235JR	13429.03	2.1 kg	200
Form C	Buried hydrants+gate valves	1150 mm (1+2)	420 mm	S235JR	13428	5.8 kg	100
Form C	Buried hydrants+gate valves	1150 mm	620 mm	S235JR	13428.01	6.4 kg	60
Form D	Gate valve DN500/600	1100 mm	1000 mm	S235JR	13430	14.0 kg	-

*(1) DIN. (2) Standard

Other versions upon request!

PU = Deliveries only possible in pack units!



Operating keys: similar to DIN 3223 form C/E for GAS square caps

DIN 3223	suitable for	Length	Material	Article No.	Weight
Form C	Triangular cap 33/43	1100 mm	S235JR	13428.04	5.7 kg
Form E	Triangular cap 15/18	750 mm	S235JR	13429.01	2.0 kg
Form C	Square cap with pin 6x60 gate valve	1100 mm	S235JR	13428.09	6.4 kg
Form E	Square cap with pin 4x40 service valve	750 mm	S235JR	13429.06	1.5 kg



Safety handwheel wrench

DN	Length	Article No.	Weight
50-150	340 mm	13920	0.7 kg
125-250	450 mm	13921	1.0 kg
250-400	620 mm	13922	1.7 kg
350-900	800 mm	13926	2.2 kg



scan me!



Subject to technical modifications!

Surface box hooks: galvanised

for chamber lids					
Round steel Ø	Handle	Length	Material	Article No.	Weight
16 mm	150 mm	600 mm	S235JR	12149.02	1.8 kg
16 mm	150 mm	800 mm	S235JR	12149.01	2.1 kg

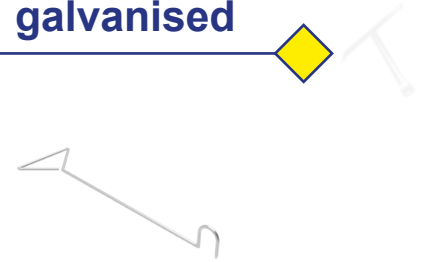

for surface box lids					
Round steel Ø	Handle	Length	Material	Article No.	Weight
16 mm	150 mm	600 mm	S235JR	12149.03	1.9 kg
16 mm	150 mm	800 mm	S235JR	12149.04	2.2 kg

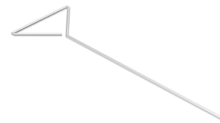

Handwheel in ergonomically shaped Metal, blue RAL 5015

DN	SQ	Ø	Article No. blue*	Weight
40/50	14/17	200 mm	13888.00	0.8 kg
65/80	17/19	250 mm	13889.00	1.3 kg
100-150	19/22	300 mm	13890.00	1.8 kg
175/200	24/27	400 mm	13891.00	3.5 kg
250-350	27/32	400 mm	13893.00	3.5 kg
400/450	32/36	400 mm	13894.00	3.5 kg
400/450	32/36	630 mm	13895.00	10.0 kg



*other colours upon request.

Handwheel in cast iron DIN 3220, GG20

DN	SQ	Ø	Article No. black*	Weight
40/50	14/17	200 mm	1081092	2.1 kg
65/80	17/19	250 mm	1081095	4.0 kg
100-150	19/22	315 mm	1081099	6.3 kg
175/200	24/27	400 mm	1081103	10.4 kg
250-350	27/32	500 mm	1081106	15.0 kg



*other colours upon request.

Screw and washer sets for installation of handwheels

DN	SQ	Screw 1*	Screw 2*	Article No.	Weight
40/50	14	M8x16 mm	M6x12 mm	21825	0.03 kg
65-150	17/19	M10x16 mm	M8x16 mm	21826	0.04 kg
175-300	24/27	M12x20 mm	M10x25 mm	21827	0.08 kg
400/450	27/32	M12x20 mm	-	10174	0.10 kg



*incl. washer



Subject to technical modifications!



ACCESSORIES

TABLE OF CONTENTS

Extension for service valves	86
Extension for gate valves	86
Locking device for service valves	86
Locking device for gate valves	86
Surface boxes	87
Support plates	87
Fixing discs	87
Covering caps	88
Centring caps	88
Bell adapters	88
Connecting pins:	
Clip-pins, Grooved pins, Slotted spring pins, Split pins, Adjusting-rings	89
Square caps / Triangular caps	90 - 91
Couplings	91

Extensions for service valves



Extension L	Article No.	Weight
Service valve 100 mm	13145	0.5 kg
Service valve 150 mm	13245	0.5 kg
Service valve 200 mm	13136	0.6 kg
Service valve 250 mm	13266	0.7 kg
Service valve 300 mm*	13146	0.7 kg
Service valve 350 mm*	13348	0.7 kg
Service valve 400 mm*	13147	0.8 kg
Service valve 450 mm*	13349	0.8 kg
Service valve 500 mm*	13148	0.9 kg

*incl. protection tube

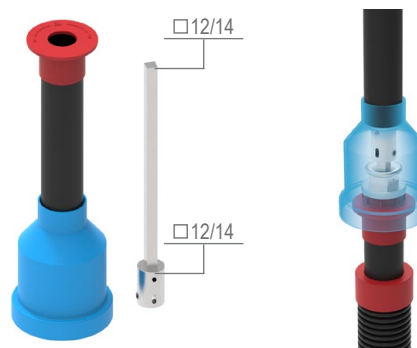

Extensions for gate valves

Extension L	Article No.	Weight
Gate valve 100 mm	13109	2.3 kg
Gate valve 150 mm	13110	2.5 kg
Gate valve 200 mm	13111	2.8 kg
Gate valve 250 mm	13345	3.1 kg
Gate valve 300 mm*	13112	3.5 kg
Gate valve 400 mm*	13346	4.1 kg
Gate valve 500 mm*	13347	4.5 kg

*incl. protection tube

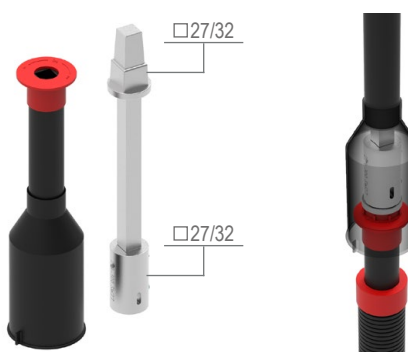

Locking device for service valves

Description	Article No.	Weight
Kit complete for spindle extension square cap 12/14 mm	17000	0.4 kg
Kit complete for spindle extension triangular cap 15/18 mm	17010	0.4 kg
Padlock, separate	17020	0.2 kg
Key, same locking, 1 pc.	17020.S	0.2 kg



Locking device for gate valves

Description	Article No.	Weight
Kit complete for spindle extension square cap 27/32 mm	17100	2.2 kg
Kit complete for spindle extension triangular cap 33/43 mm	17101	2.2 kg
Padlock, separate	17020	0.2 kg
Key, same locking, 1 pc.	17020.S	0.2 kg



scan me!



Surface boxes



Surface box similar to DIN 4056

Material	Article No.	Weight
plastic	4056.WK	6.0 kg
cast iron	4056.W2	13.0 kg



Surface box similar to DIN 4057

Material	Article No.	Weight
plastic	4057.WK	13.0 kg
cast iron	4057.W2	13.0 kg



Surface box acc. to DIN 4056 Type 2

Material	Article No.	Weight
Plastic	4056-2.WK	12.1 kg



DALMINEX support plate and DALMINEX fixing disc



DALMINEX support plate (suitable for position indicators)

Material	Article No.	Weight
Plastic	12601.01	14.0 kg



DALMINEX fixing disc suitable for DALMINEX support plate

Material	Article No.	Weight
Plastic	12602.01	1.16 kg

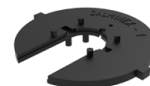

scan me!



ACCESSORIES



Covering caps

Dimensions	Color	Article No.	Weight
Ø50xØ36mm	blue	12318.02	0.01 kg
Ø50xØ36mm	red	12318.03	0.01 kg
Ø54xØ36mm	blue	12321.02	0.01 kg
Ø54xØ36mm	red	12321.03	0.01 kg

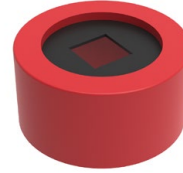

Sealing disc included. Please state rod dimensions when ordering

Centring caps

Dimensions for protection tube	Color	Article No.	Weight
Ø50mm	red	13789.03	0.04 kg
Ø54mm	blue	13790.14	0.04 kg
Ø54mm	yellow	13790.02	0.04 kg
Ø54mm	red	13790.13	0.04 kg
Ø54mm	black	13790.10	0.04 kg



Sealing disc included. Please state rod dimensions when ordering

Bell adapters / Sealing inserts

Suitable for valve	Description	Material	Article No.	Weight
EWE, VAG	Type I	PE	12511.01	0.04 kg
AVK-Mittelmann SVK VA	Insert for Type I	PE	12511.02	0.01 kg
Z-Schelle Keulahütte Lüneburg	Type II	PE	12511.03	0.03 kg
ERHARD (semicircle)	Type III	PE	12511.04	0.04 kg
EWE	-	PE	12511.00	0.01 kg
ASP, VOIGT, Friatec DAV d63 AVK Service valve	Type IV	PE	12511.05	0.05 kg
Hawle (thread)	Type VI	PE	12511.07	0.05 kg
Belgicast internal	Type III (Ø41 mm)	PE	12511.41	0.09 kg
FUCOLI	Ø81x46 mm	PE	12511.08	0.01 kg
Universal Service valve	Ø81x36 mm	EPDM	12511.09	0.01 kg
Universal DN40-150	Ø81x36 mm	EPDM	12514.11K	0.01 kg
Universal DN200-350	Ø100x36 mm	EPDM	12514.14	0.01 kg
AWP	Screw thread DVGW GW336	PE	12514.15	0.01 kg



scan me!



Subject to technical modifications!

Clip-pins



Description	Article No.	Weight
Clip-pin for Service valves	100317	0.01 kg
Clip-pin for Gate valve DN40-350	100318	0.02 kg
Clip-pin Polygon 4x62 mm	100326	0.01 kg



Grooved pins



Description	Article No.	Weight
Grooved pin Ø4x30 mm	100114	0.003 kg
Grooved pin Ø4x40 mm	100109	0.004 kg
Grooved pin Ø5x50 mm	100112	0.008 kg
Grooved pin Ø6x60 mm	100123	0.013 kg



Slotted spring pins



Description	Dimensions	Article No.
Slotted spring pin DIN1481/ISO8752	4x20mm	100296
	4x30mm	100243
	5x50mm	100221
	5x30mm	100244
	5x36mm	21071
	6x50mm	100118
	8x70mm	100184



Split pins



Description	Article No.	Weight
Split pin Ø3,2x40 mm	100155	0.003 kg
Split pin Ø4x40 mm	100213	0.004 kg
Split pin Ø4x63 mm	100309	0.006 kg



Adjusting-rings



Description	DN	Article No.	Weight
Adjusting-ring Ø30xØ20/14 mm	Service valve	100167	0.005 kg
Adjusting-ring Ø35xØ25,5x14 mm	40-150	100168	0.005 kg
Adjusting-ring Ø45xØ32x16 mm	175-350	100171	0.014 kg



scan me!



Square cap conical / ductile cast iron / galvanised*



Suitable for valve	Connection top	Connection bottom	Article No.	Weight
Service valve	27/32 mm	12/14 mm	12108.02-VK-VZ	0.7 kg
DN40/50	27/32 mm	14/17 mm	12106.00-VK-VZ	0.7 kg
DN65/80	27/32 mm	17/19 mm	12108.00-VK-VZ	0.7 kg
DN100-150	27/32 mm	19/22 mm	12108.01-VK-VZ	0.8 kg
DN175/200	27/32 mm	24/27 mm	12109.00-VK-VZ	1.1 kg
DN250-350	27/32 mm	27/32 mm	12110.00-VK-VZ	1.2 kg
DN400/450	27/32 mm	32/36 mm	12112.00-VK-VZ	1.5 kg
DN500/600	48/53 mm	36/42 mm	12113.00-VK-VZ	4.6 kg



*Spindle drilling hole cross-drilled with grooved pin

Square cap cylindrical*

Ductile cast iron			
Inner square	Connection top	Article No.	Weight
14x14 mm	12/14 mm	12106.04-VK-VZ	0.3 kg
14x14 mm	27/32 mm	12106.05-VK-VZ	0.4 kg
18x18 mm	27/32 mm	12108.05-VK-VZ	0.4 kg
25x25 mm	27/32 mm	12109.05-VK-VZ	0.6 kg



Ductile cast stainless steel			
Inner square	Connection top	Article No.	Weight
14x14 mm	12/14 mm	12106.08-VK-VA	0.3 kg
18x18 mm	27/32 mm	12108.05-VK-SS	0.4 kg
25x25 mm	27/32 mm	12109.05-VK-SS	0.4 kg



*with set screw M10

SPECIAL - Square cap / ductile cast iron / galvanised*

with pin				
Suitable for valve	Pin size	SQ	Article No.	Weight
Service valve, DN40/50	Ø4x40 mm	27/32 mm	12106.06-VK-VZ	0.4 kg
DN65-150	Ø6x60 mm	27/32 mm	12108.06-VK-VZ	0.7 kg
DN250/300	Ø20x60 mm	40/52 mm	12124	1.1 kg



*with set screw M10

with keyway			
Description	SQ	Article No.	Weight
Square cap with keyway	27/32 mm	12106.07-VK-VZ	0.4 kg



*with set screw M10



Triangular cap / ductile cast iron / galvanised*

Description	Connection top	Connection bottom	Article No.	Weight
33/43 galvanised	33/43 mm	12/14 mm	12141.12-VK-VZ	0.8 kg
33/43 galvanised	33/43 mm	14/17 mm	12141.14-VK-VZ	0.8 kg
33/43 galvanised	33/43 mm	17/19 mm	12141.17-VK-VZ	0.8 kg
33/43 galvanised	33/43 mm	19/22 mm	12141.19-VK-VZ	0.8 kg
33/43 galvanised	33/43 mm	24/27 mm	12141.24-VK-VZ	1.0 kg
33/43 galvanised	33/43 mm	27/32 mm	12141.25-VK-VZ	1.1 kg
15/18 Tele2000, galvanised	15/18 mm	12/14 mm	13760.00-VK-VZ*	0.8 kg
15/18 Tele2000, without plate	15/18 mm	12/14 mm	13766.00-VK-VZ*	0.8 kg
33/43 Tele2000, galvanised	33/43 mm	18/18 mm	13762.00-VK-VZ*	0.8 kg

*with set screw M10



Coupling / ductile cast iron / galvanised - conical both ends*

Suitable for valve	Connection	Article No.	Weight
Service valve	12/14 mm	12329.00-VK-VZ	0.5 kg
DN40/50	14/17 mm	12134.00-VK-VZ	0.5 kg
DN65/80	17/19 mm	12135.00-VK-VZ	0.6 kg
DN100-150	19/22 mm	12136.00-VK-VZ	0.8 kg
DN175/200	24/27 mm	12330.00-VK-VZ	1.0 kg
DN250-350	27/32 mm	12137.00-VK-VZ	1.3 kg
DN400/450	32/36 mm	12139.00-VK-VZ	2.1 kg
DN500/600	36/42 mm	13758.00-VK-VZ	4.8 kg

*Custom and cross-drilled holes available upon request.



Coupling according to DVGW GW336*

Ductile cast iron, galvanised				
Suitable for valve	Connection top	Connection bottom	Article No.	Weight
Service valve	20 mm	12/14 mm	12133.05-VK-GW336	0.2 kg
DN40/50	25 mm	14/17 mm	12138.01-VK-GW336	0.5 kg
DN65/80	25 mm	17/19 mm	12332.00-VK-GW336	0.6 kg
DN100-150	25 mm	19/22 mm	12333.00-VK-GW336	0.7 kg
DN175/200	30 mm	24/27 mm	12140.00-VK-GW336	0.8 kg
DN250-350	30 mm	27/32 mm	12131.00-VK-GW336	1.2 kg

Ductile cast stainless steel				
Suitable for valve	Connection top	Connection bottom	Article No.	Weight
Service valve	20 mm	12/14 mm	12133.05-VA-GW336	0.2 kg
DN40/50	25 mm	14/17 mm	12138.01-VA-GW336	0.5 kg
DN65/80	25 mm	17/19 mm	12332.00-VA-GW336	0.6 kg
DN100-150	25 mm	19/22 mm	12333.00-VA-GW336	0.7 kg
DN175/200	30 mm	24/27 mm	12140.00-VA-GW336	0.8 kg
DN250-350	30 mm	27/32 mm	12131.00-VA-GW336	1.2 kg

*Custom and cross-drilled holes available upon request.



scan me!



Subject to technical modifications!



PIPEWORK SYSTEMS

TABLE OF CONTENTS



Stainless steel flange connections

94 - 95

Stainless steel Flange connection piece with outside thread

- ◆ One-piece connection point within a flange connection
- ◆ High-grade stainless steel that meets drinking water requirements in accordance with DVGW Worksheet 541
- ◆ Welded connection piece without size limitation
- ◆ Durable and cost-effective connection
- ◆ No cavitation due to high flow speed
- ◆ Sealing surface with slots for flat sealing

Connection possibilities:

- ◆ SCHMIEDING stainless steel tapping saddle
- ◆ GEORG FISCHER connector in PE/brass
- ◆ BEULCO connector Model 77110
- ◆ VIEGA Geopress sonnector Model 9612
- ◆ PLASSON threaded Model 18030
- ◆ PLASSON coupling in PE/brass Model 9310
- ◆ FRIALEN connector

Example (illustration):

This image shows a residential water supply connected to another pipeline via a flange connection from a terminal hydrant.

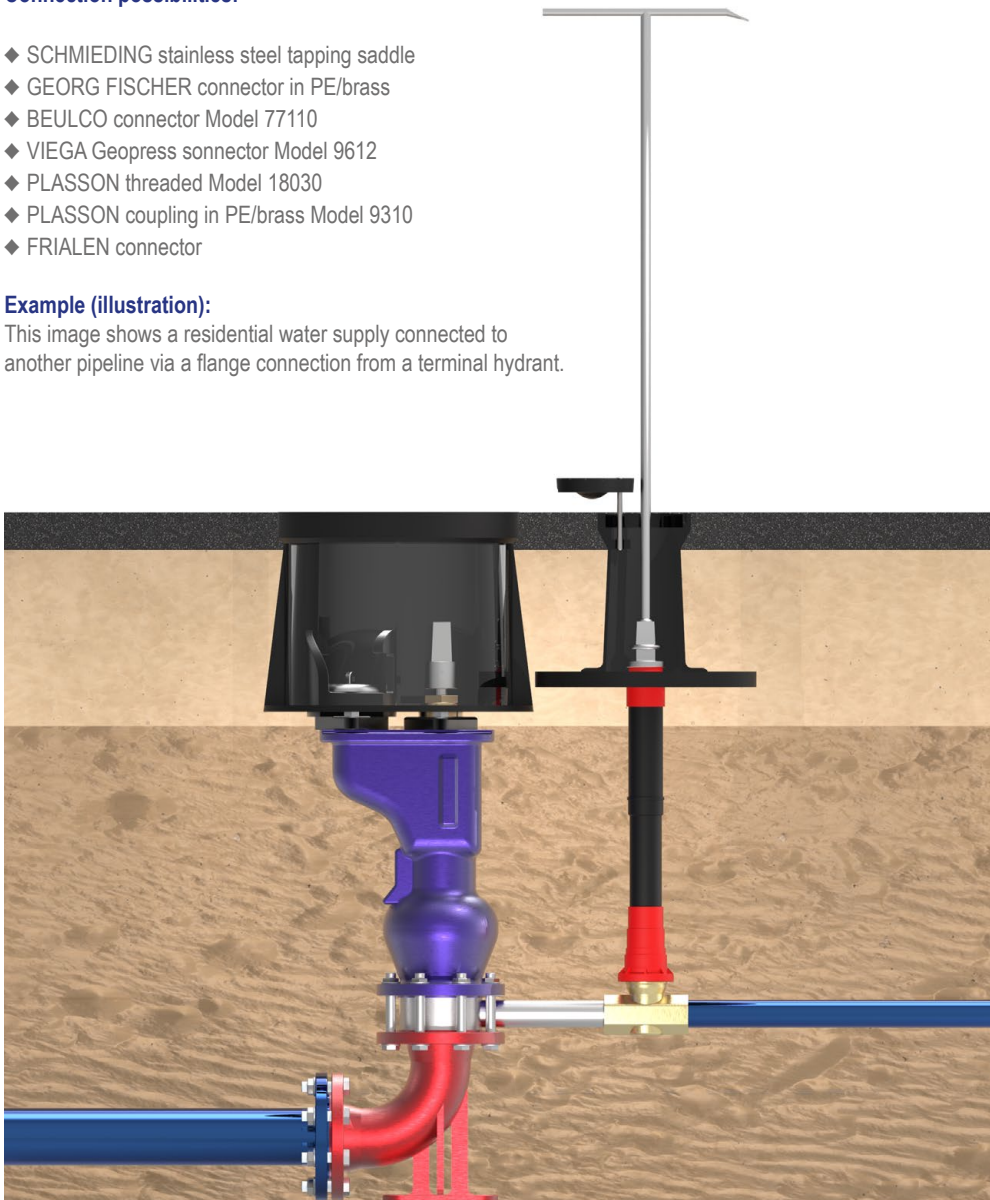

Advantages:

- ◆ Vastly reduces corrosion and encrustation of pipes
- ◆ Maintains high water quality
- ◆ Subsequent installation possible

Subject to technical modifications!



Stainless steel Flange connection piece with outside thread



Diameter	Connection size	Article No.	Weight
DN80	1"	14227	3.5 kg
	1 1/4"	14228	3.5 kg
	1 1/2"	14229	3.9 kg
	2"	14230	4.0 kg
DN100	1"	14231	3.5 kg
	1 1/4"	14232	5.0 kg
	1 1/2"	14233	3.5 kg
	2"	14234	3.5 kg

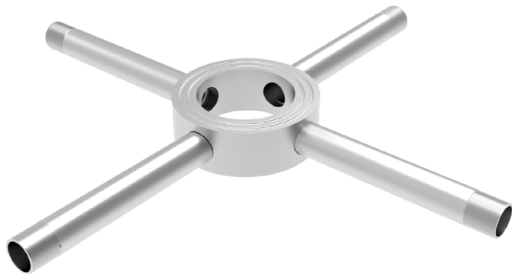

Example of installation



scan me!



Subject to technical modifications!



GENE

GENERAL TERMS & CONDITIONS

TABLE OF CONTENTS

General Terms & Conditions

98 - 99

GENERAL TERMS & CONDITIONS

§ Section 1 Scope and object of agreement

- (1) Our terms and conditions apply to the supply of movable items based on the contract concluded between us and the Customer (Purchaser).
- (2) Our terms and conditions apply exclusively. We do not recognise opposing contracting partner (Customer/Purchaser) conditions or conditions that deviate from our terms and conditions, unless we have expressly agreed to their validity in writing.
- (3) Should individual provisions be or become invalid, the remaining provisions shall remain unaffected by this.

§ Section 2 Documents for the offer and contract conclusion

- (1) Orders only become binding once the order has been confirmed. Amendments and supplements must be made in writing (Section 126 et seq. of the German Civil Code (Bundesgesetzbuch, BGB)). All offers are not binding unless they have been explicitly referred to as a binding offer.
- (2) We retain title and reserve the copyrights for illustrations, drawings, calculations and other documents. This shall also apply to written documents that are marked as confidential. Express written consent is required before these are passed on to third parties.

§ Section 3 Price and payment conditions

- (1) All prices are ex works - i.e. exclude freight, customs, import duties and packaging less VAT.
- (2) If the price changes or the assessed fee increases at the time of the offer being submitted or at the time of the service being provided due to a change in the market price or an increase by the third parties involved in the provision of the service, then the higher price shall apply. If the price is 20% or more than the agreed price, the Customer has the right to withdraw from the contract. This right is only valid immediately after the Customer has been informed of the increased price.
- (3) If the prices depend on the weight of the parts, the final price is based on the approved proof sample.
- (4) We are not tied to any previous prices in respect of new orders (or follow-up orders).
- (5) All payments are to be made to DALMINEX GmbH only, in EUR.
- (6) Unless otherwise agreed, the sales price for supplies or other services are payable within 7 days of the invoice date with a 2% prompt payment discount, and 30 days of the invoice date with no discount. Discounts may only be granted if all previous undisputed invoices that are due have been paid.
- (7) Failure to comply with payment terms or circumstances which give reason to doubt the creditworthiness of the Purchaser result in all of our receivables becoming due immediately. Furthermore, we are entitled to demand advance payment for services to be carried out, and to withdraw from the contract after an appropriate grace period has been set, or to demand compensation for damages due to default. We are also entitled to deny the Purchaser the opportunity to resell the goods and retrieve goods not yet paid for, at the cost of the Purchaser.
- (8) The Buyer is only entitled to rights of set-off if counter-claims have been legally established. A right of retention may only be exercised if its counter-claim is based on the same contractual relationship.

§ Section 4 Delivery and default

- (1) The delivery time is only complied with if the order has been clarified in full, all approvals have been given, and all documents, payments and securities required from the Purchaser have been received by the supplier. The delivery time shall be met if the delivery is ready to be sent within the agreed time period and a corresponding notification has been given to the Purchaser.

- (2) If the agreed delivery period is not met through fault of our own, the Purchaser is entitled to demand compensation for delay or withdraw from the contract after an appropriate time period has passed and to the exclusion of further claims, if he has given written notification of the rejection of the delivery when the grace period was given, provided that the Purchaser has not acted with gross negligence or intent. The compensation for delay is limited to a maximum of 5% of the part of the delivery which was not met.
- (3) Appropriate part deliveries and reasonable deviations from the amounts ordered are permitted up to +/- 10%.
- (4) If the service under contract is substantially impeded or blocked, for example through force majeure such as strikes, exports, war, blockades, a ban on imports or exports, fire, road blockages, disruptions to operations or transport, and other circumstances beyond our control, or if such an event affects our subcontractors, the period for performance is automatically extended by the length of the hindrance.
- (5) If the Purchaser does not fulfil his obligation to accept the delivery, we are not tied to the provisions on self-help sales, without prejudice to any other rights. We may also sell the delivery item in the open market without giving advance notice to the Purchaser.
- (6) If we accept returned delivery items as a gesture of goodwill, this assumes that the goods are in perfect condition and that delivery is arranged (carriage paid) once a return date has been confirmed.

§ Section 5 Packaging, shipment, transfer of risk

- (1) Unless otherwise agreed, we shall select the packaging, shipping method and transport route to the best of our judgement.
- (2) The risk passes over to the Purchaser as soon as the delivery item leaves the factory or is available to the Purchaser at the factory. However, provided that pricing has been agreed, for which the 2010 Incoterms including any supplements valid at the time the contract is concluded provide another regulation for the transfer of risk, this deviating regulation shall apply. If the delivery is delayed for reasons that we are responsible for, the risk transfers to the Purchaser when notification is given that the delivery is ready for dispatch.
- (3) The goods shall be insured against breakages and damage caused by storage, transport and fire upon the written request of the Purchaser and at the Purchaser's cost.

§ Section 6 Liability for defects

- (1) The proof samples set the standard for the quality and execution of the product, which the Purchaser submits to us for inspection on request by us. Assurances for certain delivery item properties and for mould services must be given in the written form in the order confirmation. The service description notes the technical standards. Assurances do not include the risk of consequential damages provided that we (to include our executive staff members and vicarious agents) have not acted with intent or grossly negligently. The burden of proof for intent or gross negligence lies with the Purchaser.
- (2) If we have advised the Purchaser outside of the contractual service, we are only liable for the functionality and suitability of the delivery item with express written assurance. The state of the art standard at the time of order acceptance shall be used as a basis to set the standards.
- (3) If the purchase is a commercial transaction for both parties, the Purchaser must inspect the goods immediately after receiving them, provided this is feasible in the ordinary course of business, and immediately bring any defects to our attention.
- (4) If the Purchaser does not give notice of this, the goods shall be considered to have been accepted unless there is a hidden defect which was not apparent upon inspection. Sections 377 et seq. of the German Commercial Code (Handelsgesetzbuch, HGB) also apply.

GENERAL TERMS & CONDITIONS

- (5) Claims are limited to rectifying the defect or delivering an item which is free of defects (supplementary performance), based on our choice. If there are failures in the supplementary performance, the Purchaser has the right to withdraw from the contract or reduce the contract, based on his choice.
- (6) Unauthorised subsequent work and improper handling result in losing all claims for defects. The Purchaser is only entitled to carry out subsequent improvements and demand compensation for the relevant costs of this after prior consultation with us and only to prevent disproportionately large damages or if there has been a delay in us carrying out remedial action.

§ Section 7 Liability for damages

- (1) Our liability for contractual breaches of duty and offences is limited to intent and gross negligence. This does not apply to the Customer's loss of life, physical injury or health. This also applies to minor negligence on the part of our representatives and our vicarious agents.

§ Section 8 Retention of title

- (1) The goods shall remain our property until all of our claims against the Purchaser (reserved goods) have been fulfilled, even if individual goods have been paid for. It is not permitted to pledge reserved goods or to assign them as a security.
- (2) Where reserved goods are re-sold, the Customer hereby assigns to us by way of security the receivables from their customer arising from the named transactions until all claims have been fulfilled. Where reserved goods are processed, restructured or combined with another item, we shall acquire direct title to the newly produced item. These goods shall then be considered to be the reserved goods.
- (3) Should the value of the security exceed our claims against the Purchaser by more than 10%, we may release the security provided to us in an amount that corresponds with this, at the request of the Purchaser and at our discretion.
- (4) We must be notified immediately if any third party seizes or confiscates the reserved goods. Where they are not borne by the third party, any costs incurred through intervening shall be borne by the Purchaser in all cases.
- (5) If we exercise our retention of title under the above-mentioned provisions by withdrawing reserved goods, we are entitled to sell the goods in the open market or sell them at auction. Reserved goods are withdrawn in the amount of the proceeds obtained, however no higher than the agreed delivery prices. We reserve the right to further claims for damages, in particular loss of profits.

§ Section 9 Moulds

- (1) The price for moulds also includes costs of one-off sampling, but does not include the costs of testing and processing devices or changes requested by the Purchaser. Costs for further samples for which we are responsible shall be borne by us.
- (2) Unless otherwise agreed, we are and shall remain the owners of the moulds manufactured by us or a third party contracted by us for the Purchaser. Moulds are only used for the Purchaser's order provided that the Purchaser meets their payment and acceptance obligations. We are only obligated to replace the mould free of charge if this is required in order to meet an output quantity assured by the Purchaser. Our obligation to store the mould shall expire 2 years after the last part from the mould has been delivered and once the Purchaser has been informed of this.
- (3) If it is agreed that the Purchaser shall own the mould, ownership shall transfer upon payment of the purchase price. The transfer of the moulds to the Purchaser shall be replaced by our storage period. Regardless of the Purchaser's legal right to recover possession and the useful life of the moulds, we are entitled to exclusive ownership of them until acceptance of a quantity to be agreed and/or until a certain period of time has passed. We shall identify the moulds as third-party property and, at the Purchaser's request, we shall insure these at the Purchaser's cost.

- (4) For moulds that are custom to the Purchaser under Paragraph 3 and/or for moulds that are loaned, our liability is limited to the duty of care observed in our own affairs concerning storage and care. The Purchaser shall bear the costs of maintenance and insurance. Our obligations expire if the moulds have not been collected within a certain period of time after the order has been processed and after we have requested they be collected. If the Purchaser has not fully met their contractual obligations, we have a right to withhold the moulds.

§ Section 10 Provision of materials

- (1) If materials are provided by the Purchaser, they must be delivered on time and in perfect condition at their own cost and risk, with an appropriate quantity surcharge of at least 5%.
- (2) If these conditions are not met, the delivery time shall be extended by an appropriate amount. Except in cases of force majeure, the Purchaser shall bear any additional costs incurred – including costs for interrupting production.

§ Section 11 Property rights

- (1) If we are to provide a delivery based on drawings, patterns, samples or parts supplied by the Purchaser, the Purchaser shall ensure that third party property rights are not violated as a result. We shall refer the Purchaser to known rights. The Purchaser shall indemnify us against claims of third parties and shall provide compensation for any damages. If a third party prohibits manufacture or delivery by referring to a property right, we are entitled to cease work without reviewing the legal situation.
- (2) Drawings and patterns provided to us that do not ultimately form part of an order can be returned on request. Otherwise, we are entitled to destroy them 3 months after the order has been delivered.
- (3) We are entitled to copyrights and any industrial property rights for models, models and devices, blueprints and drawings designed by us or third parties.

§ Section 12 Limitation

- (1) Our claims for payment expire by limitation in 5 years, contrary to Section 195 of the German Civil Code (Bürgerliches Gesetzbuch, BGB). The limitation period shall apply under Section 199 of the German Civil Code (Bürgerliches Gesetzbuch, BGB).

§ Section 13 Place of fulfilment, choice of law and jurisdiction

- (1) Unless otherwise specified by the contract, the place of fulfilment and payment is our place of business. The legal regulations on the places of jurisdiction shall remain unaffected provided that there is no special regulation in Paragraph 3 that states otherwise.
- (2) German law shall apply exclusively for each contract. The UN Convention on Contracts for the International Sale of Goods is excluded.
- (3) The exclusive place of jurisdiction for contracts with traders, legal entities under public law and special funds under public law is the court responsible for our place of business.

Stand 09/2016



DALMINEX GmbH
Helleforthstraße 87
D-33758 Schloß Holte-Stukenbrock

Phone: +49 (0)5207 9137 0
E-Mail: info@dalminex.de
Internet: www.dalminex.de