

SPINDLE EXTENSIONS - SPECIAL APPLICATIONS -

Telescopic Spindle Extension T4 with screw bell

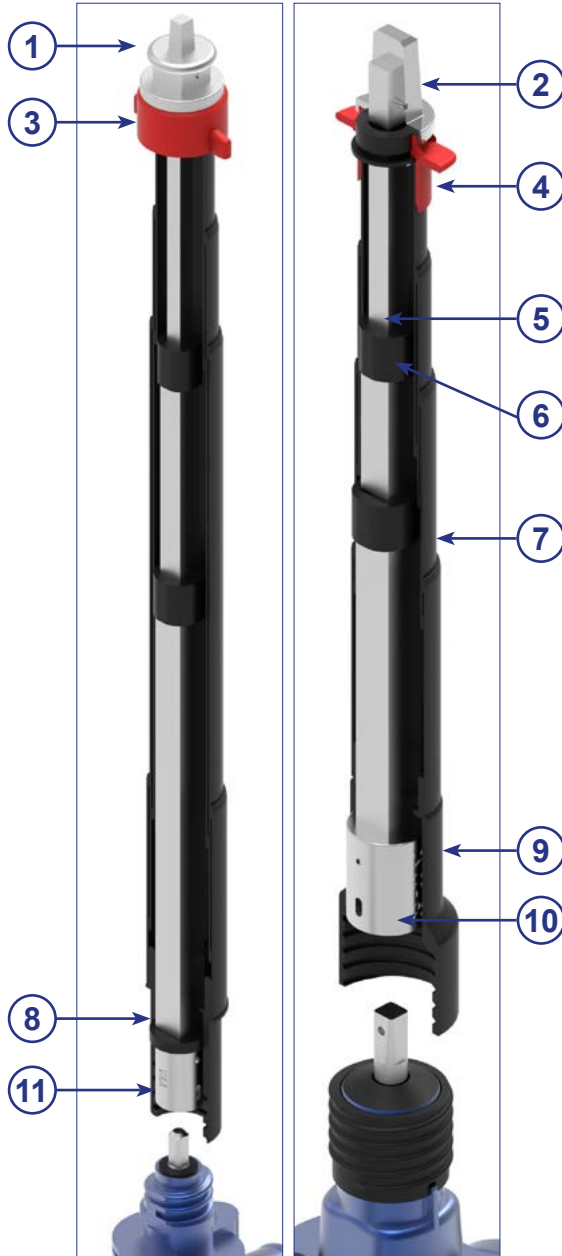

suitable for service valves

suitable for gate valves



1



Square cap SQ12/14

2



Square cap SQ27/32

3

3

3



Wing cap, standard

4



Wing cap, alternatively

2

4

5

6

7

5



Transport lock

6



PE-brake

8

11

7



Tubes

8



PE-Screw bell suitable for service valves

9



PE-Screw bell suitable for gate valves

10



Coupling DN40/50

11



Coupling

Telescopic Spindle Extension T4 for Service valves with screw bell



Valve Spindle square	CD* Cover depth	Total length (L)** Spindle extension	Article No.	Weight
Service valve SQ12	0.65 - 1.00 m	0.47 - 0.82 m	21024.HAW	1.8 kg
	1.00 - 1.80 m	0.67 - 1.54 m	21069.HAW	3.9 kg

*Cover depth measurements depend on the height of the valve used, see p. 11.

**Other lengths available upon request.

PE-screw bell with suitable connection to valve.
The screw connection is without connecting pin.

Telescopic Spindle Extension T4 for Gate valves with screw bell

Valve Spindle square	CD* Cover depth	Total length (L)** Spindle extension	Article No.	Weight
Gate valve DN40/50 SQ14	0.80 - 1.15 m	0.47 - 0.82 m	21025.HAW	3.4 kg
Gate valve DN65/80 SQ17	0.85 - 1.20 m		21026.HAW	3.6 kg
Gate valve DN100-150 SQ19	0.90 - 1.25 m		21027.HAW	3.5 kg
Gate valve DN200 SQ24	0.98 - 1.33 m		22879.HAW	3.5 kg
Gate valve DN250-350 SQ27	1.09 - 1.44 m		22880.HAW	3.6 kg
Gate valve DN40/50 SQ14	0.95 - 1.85 m	0.67 - 1.54 m	21198.HAW	4.6 kg
Gate valve DN65/80 SQ17	1.00 - 1.90 m		21199.HAW	5.3 kg
Gate valve DN100-150 SQ19	1.10 - 1.95 m		21200.HAW	5.1 kg
Gate valve DN200 SQ24	1.18 - 2.05 m		22877.HAW	5.2 kg
Gate valve DN250-350 SQ27	1.29 - 2.16 m		22878.HAW	5.2 kg

*Cover depth measurements depend on the height of the valve used, see p. 11.

**Other lengths available upon request.

PE-screw bell with suitable connection to valve.
The screw connection is without connecting pin.